

Abertillery and Llanhilleth Community Council (ALCC)

Solar Farm Grant 2024 – Application

(see criteria and process attached before applying)

Name and Address of your group or organisation:

Abertillery Learning Community (ALC)
Secondary Campus
Alma St
NP131YL

Contact name: Tracey Jarvis

Role in group: Headteacher

Telephone number: [REDACTED]

Email: [REDACTED]

What is the name of your project? ALC Community Rugby and Recreational Pitch

What are the aims of the project?

- to re-establish youth rugby in the town by making improvements to the rugby pitch at the secondary campus so that it can be made safe for use by the school and wider community rugby teams for training, matches and wider sporting events
- to make the field safe and accessible to the community for recreational activities and outdoor community events which will support positive links and opportunities with the wider community and beyond

For context, over the years many local sporting venues have fallen into disrepair and have become areas for dog-walking and/or creating a meeting ground that attracts anti-social behaviour. An example of this is the rugby pitch at the school adjacent to the Bridgend Pub. The pitch forms part of the school estate managed by the school but owned by Blaenau Gwent Council. Following a series of meetings with the school and council officers, including sites visits, it has been confirmed that there is no funding available to undertake the necessary works to bring the field up to a safe standard in order to meet health and safety and safeguarding requirements.

The W.R.U. HUB Development Officer, former Wales and British Lions' lock, Ian Evans works at the school. Ian has contributed to the plan for the development of the field stating that players, including some outstanding female players, have to travel to Newbridge to play at youth level. Indeed, some of these players recently played at the

Stadium in a cup final.

Lack of appropriate and accessible facilities for youth rugby, has resulted in a lack of clear pathways into our national sport of Youth and Senior Rugby, which underpins continued success at the highest level.

In addition to this there is no other green space close to the town centre that can be used to support the exciting range of town centre events that are growing in popularity and other community activities such as fetes and fun days.

How will your project benefit the Abertillery and Llanhilleth area or its residents?

If the pitch is redeveloped to an acceptable standard, this will make a clear statement about the importance of our national sport within the community, and it will support the school to work with the WRU Hub officer to create a high-profile pathway from youth to senior rugby.

The green space can also be used for a wide variety of community activities during lighter evenings, weekends and summer holidays including fetes, tournaments, fun days and areas for families to enjoy a picnic whilst children can play safely. The pitch will no longer be accessible to dog walkers, wandering sheep or provide an area for anti-social behaviour to occur.

Approximate number of beneficiaries Over 1000 beneficiaries each year.

What will be delivered as a result of the Solar Farm Grant?

We wish to upgrade the school's rugby pitch by installing a new set of gates to ensure prevent unauthorised access and a set of rugby posts for use by the youth of the town to play rugby at the appropriate level as well as making the space fit for community use. This will make a clear statement about the importance of rugby and physical activity and will send a positive message to the community that school is making a determined effort to provide pathways away from anti-social behaviour.

Project costs:

A. Project costs met by your group	Amount (inc. VAT)
School will provide maintenance costs as part of its SLA with Morris's of Usk	£See description
	£
	£
Sub Total	£
B. Funding being provided by other organisations	Amount (inc.VAT)
Wider funding is being explored by groups keen to support the school to look at multi-functional community use.	£See description
	£
Sub Total	£
C. Funding requested from ALCC Solar Farm Grant	Amount (inc.VAT)
Removal and replacement of suitable steel gates	£2620
Manufacture and installation of rugby posts	£4560
Sub Total	£7180
D. Total project costs (A + B + C) TOTAL	£7180

How will your project improve the local environment? The project will see the proper and safe use of a run-down rugby pitch which will be regularly maintained by the school's grounds maintenance contract. It will ensure that the pitch enhances the green space around the school site and it will deter inappropriate use and anti-social behaviour.

How does your project contribute to sustainability? For relatively small investment, the project will ensure the green space is well maintained so that it has a secure long-term future by being well used and maintained by the school and the community.

How does your project link with local schools? The project links directly to Abertillery Learning Community which is a multi-site 3-16 school. Whilst the pitch is located at the secondary campus, the primary campuses will also make use of the pitch and its rugby provision through the work with the WRU and Abertillery Rugby Club.

How does your project promote volunteering? Whilst the school will manage the rugby pitch through the school day, a next work of volunteers, who already work closely with the school, will support with the development of community access through links with the WRU, Abertillery Rugby Club and local community groups to ensure the project has a direct, tangible impact upon the community.

How does your project promote links between communities? The development of the rugby pitch will ensure there is access to all across the local community and it will bring visitors from other communities to share its use. It can also be used as a venue for a diverse range of other wider community activities such as fun days, fetes and tournaments.

How does your project help deliver the seven well-being goals in the Well-being of Future Generations (Wales) Act 2015, namely:

- **A prosperous Wales**
- **A resilient Wales**
- **A healthier Wales**
- **A more equal Wales**
- **A Wales of cohesive communities**
- **A Wales of vibrant culture**
- **A globally responsible Wales?**

.....
A prosperous Wales – pathways to successful futures with the WRU or other sporting pathway. Opportunity for income generation for the school.

A resilient Wales – raising the profile of the national sport which has been struggling with pathways from communities such as Abertillery and Llanhilleth

A healthier Wales – the provision of sport accessible to all ages and abilities in a safe, green, outdoor environment

A more equal Wales – providing a space and provision that is accessible to all

A Wales of cohesive communities – a successful rugby team and training facility will enhance cohesion within the community and instill a sense of purpose and belonging. This will contribute to tackling anti-social behaviour and dis-engagement within the town.

A Wales of vibrant culture – again this will link to raising the profile of the national sport with a sense of identity and the opportunity to host cultural events on the field.

A globally responsible Wales – team sport and bringing people together will help our community to increase awareness of social responsibility both at home and across the world.

If funding is granted, what will successful delivery of the project look like?

Successful delivery will see the rugby pitch being well maintained and well used, raising the profile of rugby and other sporting activities across the community. It will also provide a community venue for a range of activities throughout the year, enhancing community cohesion and maintaining a high quality green space.

Supporting Information

Aneurin Leisu

From: Jamie Davies <[REDACTED]>
Sent: Friday, May 3, 2024 4:11:05 PM
To: ALC
Subject: Support of community Grant

To ALC

Just a quick email in support of your application of restoring community facilities and enhancing the field behind the sports centre 3G field. Abertillery has an amazing Rugby heritage supporting all ages from under 7s to the senior teams offering families a safe place to enjoy their loved sport, proof of this has already been demonstrated at Abertillery park where volunteers have resurrected the facility's at the ground and surrounding area, which has benefited the club and area seeing the senior teams win promotions and win a Welsh cup at the nations ground in Cardiff which many dream to play.

While the impact has been greatly received in Abertillery park, the lack of other facilities for others to enjoy in the area are few and far between, surely given more places and opportunities for families to enjoy a range of sport can only benefit Abertillery and surrounding areas as a whole.

The former pitch Penybont is not currently greatly used due to the lack of investment and care over the years and would greatly benefit from development, as the schools main pitch it would be nice to see it developed for the right reasons instead of being attracting anti social behaviour or somewhere for dog walkers to leave mess and make the field unusable.

Being the Manager of the local sports centre and seeing the drop off in sport especially rugby is alarming and as a rugby coach myself its worrying for the future of the sport, I truly believe if we give families and the youth in the area the chance to play sport it can only improve the town, help with obesity and mental health and fully support the application.

Jamie Davies
Facility Manager
Aneurin Leisure Trust
[REDACTED]

Abertillery BG Rugby Football Club

Honorary Secretary: Craig Clease

Telephone: [REDACTED] e-mail: [REDACTED]

Headquarters: The Park, Glandwr Street, Abertillery, Gwent NP23 1TS

Dated May 1st 2024

Dear Town Councillors,

We would like to fully endorse and support the project to have upgrades made at the school field. The project to replace the rugby posts is also being supported by the local rugby community hub officer, Ian Evans. In conjunction with Ian and the school, we are fully supportive of anything that can help facilitate rugby in our community, particularly at all mini and junior age groups for both boys and girls rugby.

At Abertillery BG RFC, we are re-booting a former Welsh Rugby powerhouse, and turning it into a community rugby hub that is fit for the future.

With a revitalised and dedicated club committee, and a committed band of volunteers, we have

already reinvigorated our club with successes both on and off the field.

As a not-for-profit organisation we have managed to combine a huge amount of volunteering and various small grants, along with various other fundraising efforts to resurrect the facility at Abertillery Park, which we now hold in long term lease after asset transfer from BGCBC. Most pleasing for us is that we regularly have over 150 young people within our mini, junior, and youth age groups (Under 7's to Under 18's) using the new rugby club for training, playing, hosting various parties and regular events for the community at large.

Having any additional facilities for the community to use in the town is good for us as a club, and for the children and young people who can benefit from playing the game.

We hope you look favourably on the application for funding from the school and others who are making their time and effort available to make the project a reality.

Yours Sincerely, with kindest regards

Craig Clease,

Hon. Secretary, Abertillery BG RFC.

pentref@tyleri.org

As the only piece of land on the flat remaining open to local residents in the valley, the field is currently used in the afternoons, at weekends and in the holidays by parents with children and by teenagers. Could some degree of informal community use be maintained within the future plan? Although it would take coordination and volunteer support, perhaps opening the field for local people on weekday afternoons and at certain times at the weekend would be possible.

A community engagement event onsite would be a good opportunity to get local residents on board with the plan, to discuss the reasons why the field might need to be secured/gated, to tackle some of the issues (littering, inconsiderate dog ownership, off road vehicles, etc.) that impact on public spaces, to highlight possibilities for future use and to generate volunteer support. A loss of the sense of

connection to/ownership of local facilities is a driver for resentment and apathy across the valley and is a key factor in antisocial behaviour. Large scale, meaningful community engagement with detailed evidence of local input and support would go a long way to counteract this as well as potential criticism.

Will you (and when will you) supply completion reports / evidence / photos?

Reports, evidence and photos will be provided by the school on a quarterly basis or as required.

Is your organisation a: Charity/community group/sports club/company/not for profit business/other (explain and provide evidence)
ALC is a 3-16 school

Payee name: Abertillery Learning Community

Signed: T Jarvis

Print Name: Tracey Jarvis Date 7th May 2024

This form must be submitted with any relevant supporting documents you wish to submit (e.g. business plan, group constitution, bank or financial statements, letters of support etc) to Abertillery and Llanhilleth Community Council by Friday 31st May 2024, either by post to Town Clerk, Abertillery and Llanhilleth Community Council, Mitre Street, Abertillery, NP13 1AE or email clerk@abertilleryandllanhilleth-wcc.gov.uk.

Letter of Support for ALC Community Rugby and Recreational Pitch Project

Dear Abertillery and Llanhilleth Community Council,

I am writing to express my very strong support for this project, ALC has demonstrated exceptional commitment and dedication to our youth and community activities for our area over many years through very difficult times, with the vision for stronger links between the learning community and the local community and this project I believe would build on this.

I am very saddened and angry to hear about our youth on the news in a negative way and can't help feel that the neglect of our local area has fueled a spike in antisocial behavior, during my time as chairman of ALCC my appeal was "Street Games" I trained and volunteered as a Sports Leader and working alongside our local community youth, coaches and Sport Wales, I helped arrange, support and put on street games and other community sporting events in our local area, many of these events being held on the Recreational Pitch which is the proposed site for this much needed project, the Recreational Pitch has fallen into disrepair and has become an area for dog walking and a meeting ground that attracts antisocial behaviour.

I have had the privilege of witnessing firsthand the outstanding work and positive impact brought about by sports and youth engagement in our area, this project would help and support other projects in our area promoting positive steps towards well-being, bringing the community closer together and tackling antisocial behaviour and social isolation, by getting our youth involved in sport and starting conversations, building self confidence and sign posting on to other positive events and activities, many of which could also be held on this Recreational Pitch

This project fits the aims set out in the approved "Abertillery Placemaking Plan September 2023" which outlines the need for "Sport For Everyone" allowing everyone to enjoy the benefits of nature and the natural environment by supporting existing sports, improving existing facilities which need investment and linkage to "Welsh Sports Strategy" and Welsh Government "Climbing Higher Strategy" Greater uptake from younger groups, community benefit, community health, well-being and social inclusion, also providing a community space for other community based activities.

I am confident that the ALC Community Rugby and Recreational Pitch Project will make a significant impact on our local community and positively influence the lives of our local community, their dedication, passion, and expertise make them an invaluable asset to any organization, project or initiative.

Please feel free to contact me at email [REDACTED] com or mobile [REDACTED] if you require any additional information or if I can provide further support for this project, I am more than happy to assist in any way I can.

Thank you for considering my support of this project, I am confident that their ongoing effects will yield remarkable results and create lasting change for the better

Yours Sincerely,

Ivor Beynon



ALCC ClerkMailbox

From: Jodie Withers · [REDACTED]
Sent: 11 June 2024 13:09
To: ALCC ClerkMailbox
Cc: Tracey Jarvis
Subject: ALC Bank Details
Attachments: Bank details_2024.pdf

Good afternoon Erika,

Please find attached the relevant bank details as requested. The grant would go into the main school budget; the account for which is managed by Blaenau Gwent County Borough Council.

Please do not hesitate to contact me if you have any questions.

Kind regards,
Jodie



Jodie Withers
Finance & Data Manager
Abertillery Learning Community
Secondary Campus
Alma Street
Abertillery, Gwent
NP13 1YL
Tel: 01495 393911
Email: jodie.withers@abertillery3-16.co.uk
Web: www.abertillery3-16.co.uk



From: Tracey Jarvis
Sent: 11 June 2024 12:22
To: Jodie Withers · [REDACTED]
Subject: [REDACTED]

From: ALCC ClerkMailbox <clerk@abertilleryandlanhilleth-wcc.gov.uk>
Sent: 04 June 2024, 12:05
To: Tracey Jarvis · 
Subject: Solar Farm Grant Application

 You don't often get email from clerk@abertilleryandlanhilleth-wcc.gov.uk. Learn why this is important
Good afternoon Tracey

Thank you for completing and returning your Solar Farm grant application. We need clarification on a few points and some further information before we can pass the application to Council.

1. Please supply your bank details. Account name, sort code and account number.
2. Do you have a separate account set up for this project or would the money be going into the main school account?

We would be grateful if you could inform us of this information as soon as possible

Kind regards

Erika Davies

Deputy Clerk

Phone | Ffon: 01495 217323

Website | Gwefan: <http://www.abertilleryandllanilleth-wcc.gov.uk>

Council Offices, Mitre Street, Abertillery, Blaenau Gwent, NP13 1AE

Swyddfaeydd y Cyngor, Haol Mitre, Abertylan, Blaenau Gwent, NP13 1AE



Abertillery
Learning Community

Tracy Jarvis
Headteacher

Abertillery Learning Community:-

Secondary Campus - Alma Street, Abertillery, Gwent, NP13 1YL

Roseberyworth Primary Campus - Roseberyworth Rd, Abertillery, Gwent, NP13 1SR

Six Bells Primary Campus - Six Bells Rd, Six Bells, Abertillery, Gwent, NP13 2UJ

Tilbury Street Primary Campus - Tilbury St, Abertillery, Gwent, NP13 1HN



This email and any attachments to it may be confidential and are intended solely for the use of the individual to whom it is addressed. Any views or opinions expressed are solely those of the author and do not necessarily represent those of Abertillery Learning Community. If you are not the intended recipient of this email, you must neither take any action based upon its contents, nor copy or show it to anyone. Please contact the sender if you believe you have received this email in error. Abertillery Learning Community checks all emails and attachments for known malware, however, you are advised that you open any attachments at your own risk.

This email has been scanned for spam & viruses. If you believe this email should have been stopped by our filters, [click here](#) to report it.

Revenues Section

The General Offices, Steelworks Road, Ebbw Vale, NP23 8DN

T: (01495) 355212 F: (01495) 355788

E: revenues@blaenau-gwent.gov.uk



Bank Account Details

Bank Details: Barclays Bank PLC, Leicester LE87 2BB

Account Name: Blaenau Gwent County Borough Council

Sort Code: [REDACTED]

Account Number: [REDACTED]

IBAN: GB47BAR20566460363324

Kind regards

T M Thomas

Revenues Development & Control Officer

Abertillery and Llanhilleth Community Council (ALCC)

Solar Farm Grant 2024 – Application

(see criteria and process attached before applying)

Name and Address of your group or organisation:

TYLERYAN BELLES SPORTS ASSOCIATION LTD

Contact name: RACHEL TAYLOR

Role in group: TREASURER & DIRECTOR

Telephone number: [REDACTED]

Email: [REDACTED]

What is the name of your project? MODERNISING AND PROTECTION OF THE ROSEYWORTH PLAYING FIELDS

What are the aims of the project?

- * IMPROVE THE TOILET FACILITIES IN THE CHANGING ROOMS TO A MODERN DAY STANDARD FOR ALL TEAMS
- * RENEWING KITCHEN COOKING EQUIPMENT AND EQUIPMENT PAT CHECK
- * ADDING STORAGE CUPBOARD FOR SECURELY STORING CLEANING EQUIPMENT
- * BOILER REPAIRS AND DEFIB PADS

How will your project benefit the Abertillery and Llanhilleth area or its residents?

OVER 200 MEMBERS USE THESE FACILITIES UPTO 5 DAYS A WEEK, WE HOST HOME GAMES WEEKLY WHICH HOSTS OVER 100 PLAYERS FROM MANY LEAGUES IN SOUTH WALES. IMPROVING THE TOILETS WILL ENABLE MEMBERS TO HAVE ACCESS TO HYGENIC FEMALE AND MALE TOILETS ON SITE INSTEAD OF UNISEX.

BEING AN ASSOCIATION WHICH HAVE AN ALL GIRLS FOOTBALL CLUB WE NEED TO ACCOMODATE FAW STANDARDS AND CHILD PROTECTION GUIDELINES

WE ALSO HIRE THE FACILITIES TO A.L.C SO OUR COMMUNITY CAN UTILISE THE FACILITY

Approximate number of beneficiaries 200 - 500 PLUS

What will be delivered as a result of the Solar Farm Grant?

REPLACEMENT OF 2 NEW TOILETS ALONG WITH NEW WOODWORK AND DOORS. CURRENTLY OVER 60YRS OLD AND DAMAGED
NEW KITCHEN EQUIPMENT AND A SECURE STORAGE CUPBOARD TO HOLD ALL CLEANING CHEMICALS THAT ARE USED ON SITE
BOILER REPAIR TO IMPROVE THE HEATING AND HOT WATER USAGE. AND REPLACEMENT DEFIB PADS

Project costs:

A. Project costs met by your group		Amount (inc. VAT)
VOLUNTEERS PAINTING	2 PERSON X 6HRS @ £11.44	£ 137.28
SKIP HIRE		£ 250.00
PURCHASE AND RESOURCE MATERIALS	1 PERSON X 3 HRS @ £11.44	£ 34.32
Sub Total		£ 421.60
B. Funding being provided by other organisations		Amount (inc. VAT)
		£ 0.00
		£
Sub Total		£ 0.00
C. Funding requested from ALCC Solar Farm Grant		Amount (inc. VAT)
SUPPLY AND FIT NEW TOILETS WOODWORK AND STORAGE CUPBOARD		£ 1200.00
DEFIB PADS AND SAFETY CHECK ON NEW KITCHEN EQUIPMENT		£ 150.00
PURCHASE OF KITCHEN WARE		£ 250.00
PAINT, PAINTING EQUIPMENT, DOOR LOCKS, HANDLES AND BRACKETS		£ 450.00
Sub Total		£ 400.00
BOILER REPAIRS REPLACEMENT CYLINDERS		£ 1000.00
MOBILE DEFIB FOR SENIOR TEAM AWAY GAMES		
D. Total project costs (A + B + C) TOTAL		£ 3871.60

£3450

How will your project improve the local environment?

Green Spaces: Enhancing green spaces around the facility contributes to better air quality and provides a pleasant environment for visitors and the community

Low-emission Materials: will be used i.e. paints, adhesives, reducing air pollution and improves indoor air quality...

How does your project contribute to sustainability?

Water Efficiency: Installing modern, water-efficient fixtures reduce water consumption.

Waste Reduction: By improving the waste management systems in toilet facilities, such as installing proper recycling bins and using biodegradable or recycled paper products, the sports club can minimize waste sent to landfills.

Economic Sustainability Cost Savings: Reduced water and energy usage translates directly into lower utility bills making the sports club more financially sustainable.

Long-term Durability: Modern fixtures and materials will last longer and will take less to maintain

How does your project link with local schools?

YES ABERTILLERY COMMUNITY SCHOOL CAMPUSES USE THE FACILITY FREE OF CHARGE FOR MENTAL AND WELL BEING ACTIVITIES AND SUMMER SPORTS DAYS

How does your project promote volunteering?

We are a voluntary association. Volunteering with a sports club provides opportunities for people to connect with others who share similar interests, leading to the formation of new friendships and networks. Those in coaching or mentorship roles, serve as positive role models for young participants, inspiring them to stay active and involved in the community.

Voluntary sports clubs are vital in promoting and supporting volunteering within the community. They provide structured opportunities, foster skill development, engage diverse populations, support health and well-being, and build community resilience. By offering a platform for meaningful involvement, sports clubs not only enhance their own operations but also contribute significantly to the social, cultural, and economic vitality of the community

How does your project promote links between communities?.....

Partnering with BGCC schools to offer after-school sports programs or physical education support

Collaborating with local businesses for sponsorships, equipment donations, and event support helps integrate the sports association into the broader community and supports local economic development.

Supporting the ALCC with community events is Party in the Park Hosting social events, such as community picnics, or holiday parties, helps build strong relationships among community members and creates a sense of belonging.

How does your project help deliver the seven well-being goals in the Well-being of Future Generations (Wales) Act 2015, namely:

- A prosperous Wales
- A resilient Wales
- A healthier Wales
- A more equal Wales
- A Wales of cohesive communities
- A Wales of vibrant culture
- A globally responsible Wales?

The Well-being of Future Generations (Wales) Act 2015 sets a visionary framework aimed at improving the social, economic, environmental, and cultural well-being of Wales. Modernizing our sports buildings to meet contemporary standards directly supports the Act's seven well-being goals:

A Prosperous Wales: Investing in modern sports facilities will boost local economies by creating work for local companies during the renovation phase and attracting more visitors and events post-completion. This economic stimulus can provide sustained benefits to our communities.

A Resilient Wales: Upgrading our sports infrastructure can include sustainable building practices and energy-efficient technologies. This not only reduces our carbon footprint but also ensures that our facilities are prepared to withstand future environmental challenges, contributing to a resilient Wales.

A Healthier Wales: Modern sports facilities encourage greater participation in physical activities by providing safe, accessible, and appealing environments. Regular physical activity is crucial for preventing chronic diseases, improving mental health, and enhancing overall quality of life. This aligns with the Act's goal of improving public health and well-being.

A More Equal Wales: By ensuring that modernized sports facilities are accessible to all, regardless of age, ability, or socio-economic background, we promote inclusivity and equality. Everyone in our community deserves the opportunity to benefit from high-quality recreational spaces.

A Wales of Cohesive Communities: State-of-the-art sport facilities serve as community hubs where people can gather, interact, and build strong social bonds. These connections foster community spirit and collective well-being, crucial for cohesive and supportive communities.

A Wales of Vibrant Culture and Thriving Welsh Language: Modern facilities can support a diverse range of sports and cultural activities, including those that celebrate and promote Welsh heritage and language. This supports cultural vitality and pride in our national identity.

A Globally Responsible Wales: By adopting best practices in sustainable construction and operation, we set a positive example for other regions and contribute to global sustainability efforts. This demonstrates our commitment to being responsible global citizens.

The modernization of our sports buildings represents a strategic investment in the future of our community. By aligning this initiative with the Well-being of Future Generations (Wales) Act 2015, we ensure that our actions today pave the way for a healthier, more equitable, and sustainable tomorrow.

(continue on a separate sheet if needed)

I urge you to consider the long-term benefits of this modernization project and to support efforts to secure the necessary funding and resources. Together, we can create a legacy of well-being for future generations.

If funding is granted, what will successful delivery of the project look like?

The modernized sports facility, funded by the grant, will improve sustainability. It will provide a safe, accessible, and welcoming environment for all community members, enhancing the overall well-being with modern, hygienic restrooms and life saving equipment.

The upgrades will not only meet the current needs of the community but also ensure long-term benefits for future generations.

Will you (and when will you) supply completion reports / evidence / photos?

We will support you with before and after photos and costings as soon as the project was completed we anticipate for this to be completed by the end of the year, depending on when the funds were released

Is your organisation a:

Charity/community group/sports club/~~company/not for profit business~~/other (explain and provide evidence)

we are a company limited by guarantee not for profit
Company no

Payee name:

ts Association Ltd

Signed:

Print Name:

Rachel Taylor

Date:

29.05.2024

This form must be submitted with any relevant supporting documents you wish to submit (e.g. business plan, group constitution, bank or financial statements, letters of support etc) to Abertillery and Llanhilleth Community Council by Friday 31st May 2024, either by post to Town Clerk, Abertillery and Llanhilleth Community Council, Mitre Street, Abertillery, NP13 1AE or email clerk@abertilleryandllanhilleth-wcc.gov.uk.



50 Coed Calynen Drive
Abercarn
Newport
UK
nevans7@sky.com
07976 505588

Quote

QT00018

Tyleryan Belles

Date 21 May 2024
Expiry Date 20 June 2024

remove existing toilets
remove redundant overflow pipes
extend cold water feeds to accommodate closed coupled toilets
install 2x closed coupled toilet
construct storage cupboard
paint door & toilet cubicles

Subtotal 1,200.00

Total GBP 1,200.00

Terms:

Quote valid for 30 days after which price is liable to change in line materials prices

ALCC ClerkMailbox

From: rachel taylor
Sent: 04 June 2024 12:25
To: ALCC ClerkMailbox
Subject: Re: Solar Farm Grant Application

Thank you for your reply.

Bank acct name Tylieryan belles sports association ltd
(TBSA) business account

Sort code
Acct no

Committee Members are

Chair Rachel taylor
Secretary Daniel Went
Treasurer Rachel Taylor

Thank you

Sent from Outlook for Android

From: ALCC ClerkMailbox <clerk@abertilleryandllanhilleth-wcc.gov.uk>
Sent: Tuesday, June 4, 2024 12:03:34 PM
To: 'rachel taylor'
Subject: Solar Farm Grant Application

Good afternoon Rachel

Thank you for completing and returning your Solar Farm grant application. We need clarification on a few points and some further information before we can pass the application to Council.

1. Please supply your bank details. Account name, sort code and account number. Is this a business account?
2. Do you have a management committee/structure? For example, a secretary, treasurer and chair? If so, what are their names?

We would be grateful if you could inform us of this information as soon as possible

Kind regards

Erika Davies

Deputy Clerk

Phone | Ffôn: 01495 217323

Website | Gwefan: <http://www.abertilleryandllanhlleth-wcc.gov.uk>

Council Offices, Mitre Street, Abertillery, Blaenau Gwent, NP13 1AE

Swyddfeydd y Cyngor, Haol Mitre, Abertyleri, Blaenau Gwent, NP13 1AE

This email has been scanned for spam & viruses. If you believe this email should have been stopped by our filters, [click here](#) to report it.

Abertillery and Llanhilleth Community Council (ALCC)

Solar Farm Grant 2024 – Application

(see criteria and process attached before applying)

Name and Address of your group or organisation:

Adam Street Community Allotment Association

Adam Street, Abertillery, Blaenau Gwent, NP13 1ET

Contact name: Ingrid Sourbutts

Role in group: Allotment Auditor

Telephone number: Mobile;

Email:

What is the name of your project?

The Adam Street Community Allotment Regeneration Project

What are the aims of the project? 1, Secure tools for the plot holders. 2, Upgrade apiary facilities
2, Upgrade apiary facilities and replace aging equipment to enhance efficiency. 3, Repair and preserve the lockup.
4, Increase security and preserve the lockup with metal sheets and eco-friendly paint. 5, Install bilingual signage
to preserve and promote our cultural heritage. 6, Assist less-able members of the allotment by providing a
lightweight battery-powered rotovator and multi-use trailer wheelbarrows.

How will your project benefit the Abertillery and Llanhilleth area or its residents?

Our project benefits Abertillery and Llanhilleth by providing accessible green spaces, fostering community engagement, and promoting sustainable living practices. Residents can grow their own food, access fresh produce, and participate in educational workshops, enhancing well-being and community cohesion. Through these initiatives, we create a healthier, more vibrant environment for all by improving our apiary we can continue to supply the community of Blaenau Gwent and Beyond with pure honey.

Approximate number of beneficiaries 500 See appendix 1

What will be delivered as a result of the Solar Farm Grant?

See appendix 2

Project costs:

A. Project costs met by your group	Amount (inc. VAT)
See Appendix 3	£ 2165.62
	£
	£
Sub Total	£ 2165.62
B. Funding being provided by other organisations	Amount (inc.VAT)
N/A	£ 0
	£
Sub Total	£
C. Funding requested from ALCC Solar Farm Grant	Amount (inc.VAT)
See Appendix 3	£ 12023.64
	£
Sub Total	£
D. Total project costs (A + B + C)	TOTAL
	£ 14189.26

How will your project improve the local environment?

The Adam Street Regeneration Project will enhance the local environment by revitalizing infrastructure, promoting composting, and boosting pollination through an expanded apiary. New compost bins and environmentally friendly practices will enrich the soil and reduce waste. This will create a more resilient, sustainable community space for Abertillery and Blaenau Gwent.

How does your project contribute to sustainability?

The Adam Street Regeneration Project promotes sustainability by enhancing local food production,..... minimizing waste with composting, and supporting biodiversity through expanded pollination efforts. Our focus on environmentally friendly practices and organic gardening fosters a resilient, self-sustaining ecosystem, ensuring long-term benefits for the community. Enthusiastic volunteers are eager to share their skills and knowledge as well as their produce.

How does your project link with local schools?

The Adam Street Community Allotment Regeneration Project collaborates with the eco-club of Abertillery Comprehensive School and pupils from Abertillery Primary School. Together, we provide educational workshops on food production and environmental stewardship. Students engage in hands-on activities such as gardening and beekeeping, fostering lifelong skills and a deeper connection to nature. These initiatives inspire future environmental stewards, promoting community engagement and responsibility.

How does your project promote volunteering?

The Adam Street Community Allotment Regeneration Project fosters volunteering through diverse opportunities, including maintaining allotments and managing a successful apiary. Outreach programs and community events cultivate a culture of volunteerism, empowering individuals to contribute their time and skills. This collective effort enriches the local environment and strengthens social bonds within the community, fostering connections with like-minded organizations and contributing to their projects.

How does your project promote links between communities?

The Adam Street Regeneration Project fosters community links through shared spaces, collaborative activities, and cultural exchange events. By encouraging interaction and cooperation, we strengthen social bonds and promote understanding among diverse groups. Facilitating connections and partnerships enhances social cohesion and fosters a sense of belonging across communities. We are proud to collaborate with organizations such as Caffi Tyler, Pentrif Tilley, Abertillery Comprehensive School, Abertillery Primary School, and the local Crime Prevention Group. Our apiary also has links with Torfaen and Monmouthshire through the Gwent Beekeeping Society and Coleg Gwent.

How does your project help deliver the seven well-being goals in the Well-being of Future Generations (Wales) Act 2015, namely:

- **A prosperous Wales**
- **A resilient Wales**
- **A healthier Wales**
- **A more equal Wales**
- **A Wales of cohesive communities**
- **A Wales of vibrant culture**
- **A globally responsible Wales?**

See Appendix 4

.....

.....

.....

(continue on a separate sheet if needed)

If funding is granted, what will successful delivery of the project look like?

Successful delivery entails revitalised infrastructure, thriving allotments, and an expanded apiary, bolstered by engaged volunteers and community partnerships. The allotment will serve as a vibrant hub for sustainable food production and environmental education, fostering community pride and ownership. Improved facilities and increased biodiversity will contribute to a healthier, more resilient local environment for generations to come.

Will you (and when will you) supply completion reports / evidence / photos?

Completion reports, evidence, and photos will be promptly supplied within three months, showcasing the project's achievements and impact. These documents will provide transparency and accountability, ensuring stakeholders are informed and engaged in the project's progress. Our commitment to timely reporting reflects our dedication to transparency and effective communication.

Is your organisation a Charity/community group/sports club/company/not for profit business/other (explain and provide evidence)

Adam Street Allotment Association

Small Holdings and Allotments Act 1908

See Appendix 5

Payee name:

Adam Street Community Allotments Association

Signed:

Print Name:

SUSAN PRICE (TREASURER)

Date:

29/5/24

This form must be submitted with any relevant supporting documents you wish to submit (e.g. business plan, group constitution, bank or financial statements, letters of support etc) to Abertillery and Llanhilleth Community Council by Friday 31st May 2024, either by post to Town Clerk, Abertillery and Llanhilleth Community Council, Mitre Street, Abertillery, NP23 1AE or email clerk@abertilleryandllanhilleth-wcc.gov.uk.

The Adam Street Regeneration Project

Grant Funding Proposal ALCC Solar Farm Grants 2024

Appendices

The Adam Street Regeneration Project

Contents

Page 3.	Appendix 1:	Approximate number of beneficiaries?
Page 4 – 14	Appendix 2:	What will be delivered as a result of the Solar Farm Grant?
Page 15	Appendix 3:	Project Costs
Page 16-17	Appendix 4:	Adherence to Wales Act 2015 (Seven well-being goals)
Page 18	Appendix 5:	Adam Street Allotment Constitution

Appendix 1:

Approximate number of beneficiaries?

Approximately 500 allotment members benefit directly, as each of the 30 plot holders has at least 6 family members who will benefit, plus about 5 friends to whom they may give produce, each with at least 4 family members. Additionally, we donate to the food bank and supply vegetables to Caffi Tyler for their Free Soup Friday, benefiting approximately 50 more people. This way, businesses supplied with local honey and the wider Abertillery community benefit from bee pollination, honey sales, and environmental education.

Appendix 2:

What will be delivered as a result of the Solar Farm Grant?

Appendix 2.1

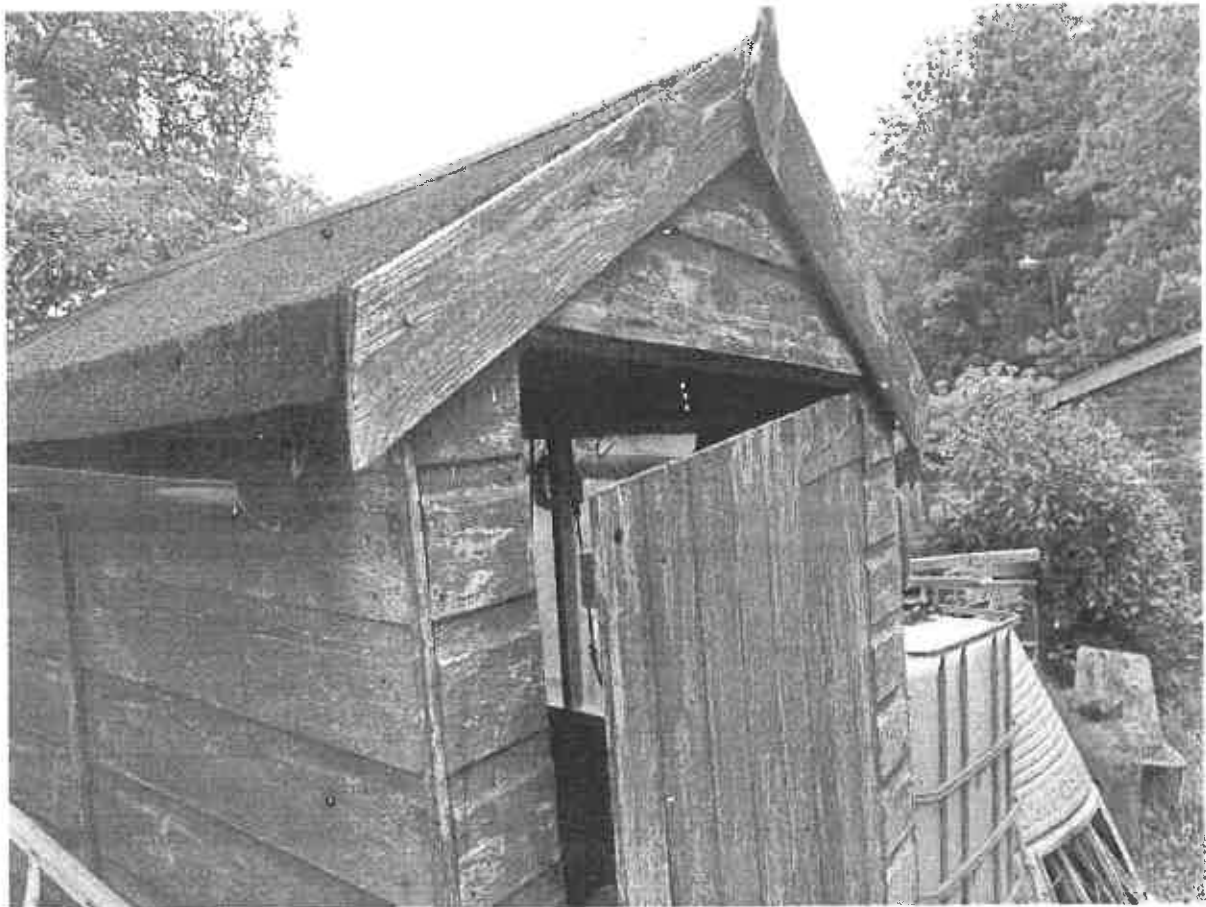

Allotment member sheds

10 sheds; 6x4 tongue and groove, standard apex. Including oil based treatment, bearers, padbolt and window

£4750 inc VAT

<https://www.daviestimberwales.co.uk/>

Appendix 2.2

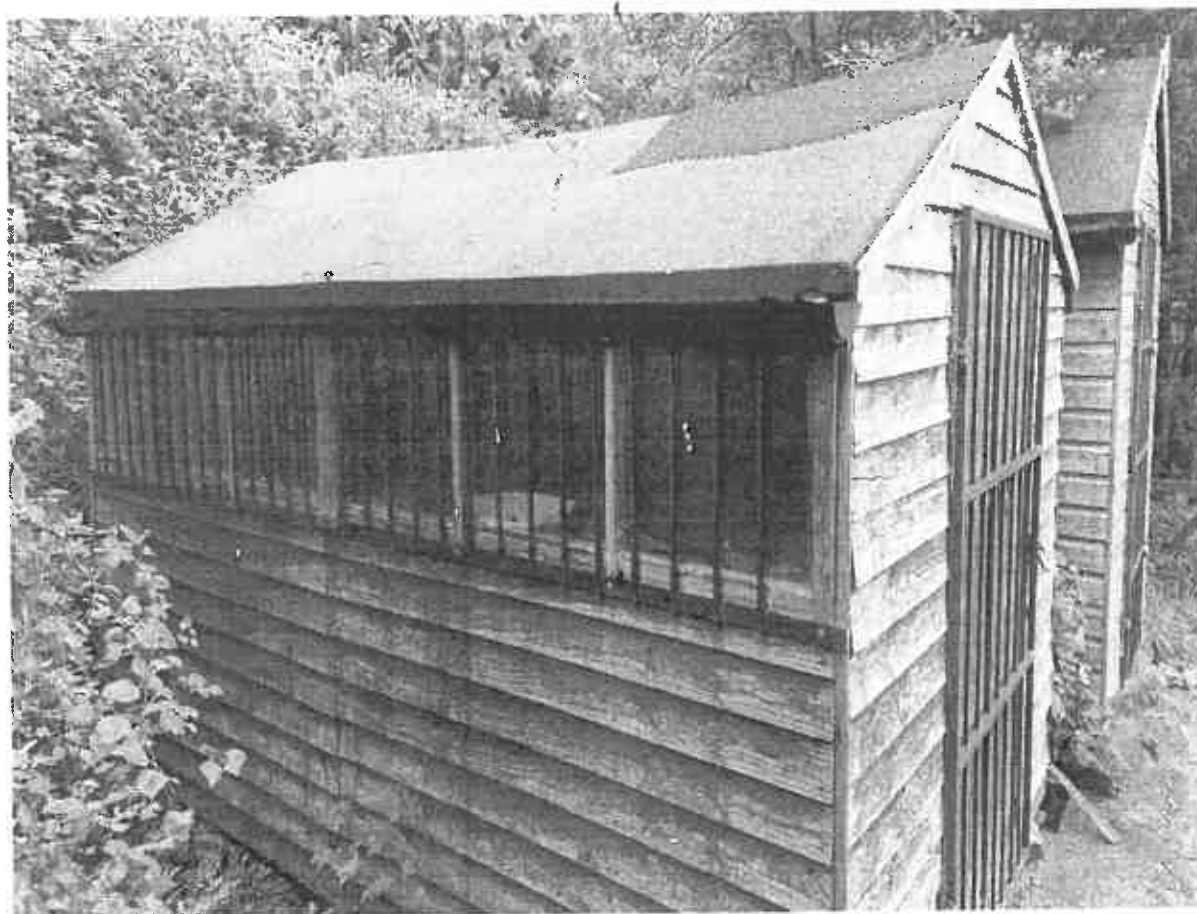

Additional shed for the apiary

1 shed; 6 x 12 tongue and groove, standard apex. Including oil based treatment, bearers, padbolt and window

£950 inc VAT

<https://www.daviestimberwales.co.uk/>

Appendix 2.3



10 padlocks for the smaller sheds and 1 larger padlock for the apiary shed

Ten sheds, £99.99

Apiary padlock £7.99

£107.98

DIY centre abertillery

Appendix 2.4

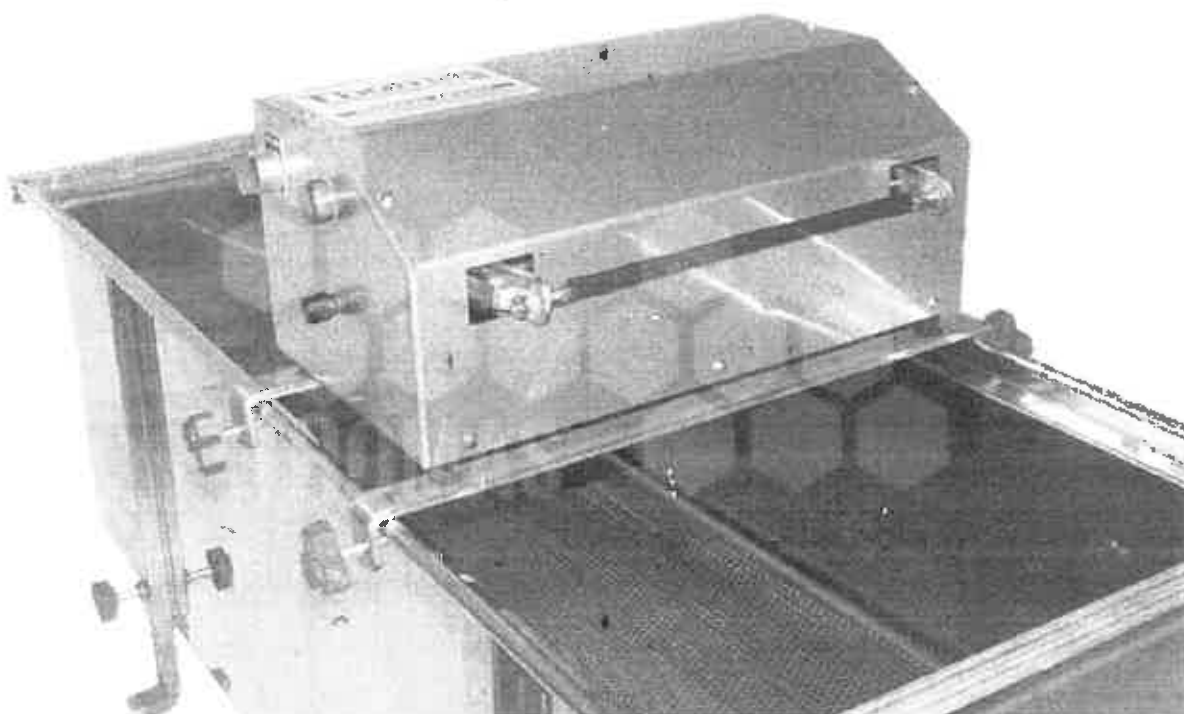

Caillas uncapping machine

Delivered £2277.80

<https://www.thorne.co.uk/processing/uncapping/uncapping-trays-machines/caillas-uncapping-machine-delivered-or-collected.html?sku=8103>

Appendix 2.5



Logar 12 Frame Electric Radial Stainless Steel Extractor

Delivered £1452

<https://www.thorne.co.uk/processing/extraction/extractors/logar-extractors/logar-12-frame-electric.html?sku=5411>

Appendix 2.6



10 compost bins
£470 (£45 per unit + £20 delivery)
<https://www.abergavennygardencentre.com/>

Appendix 2.7

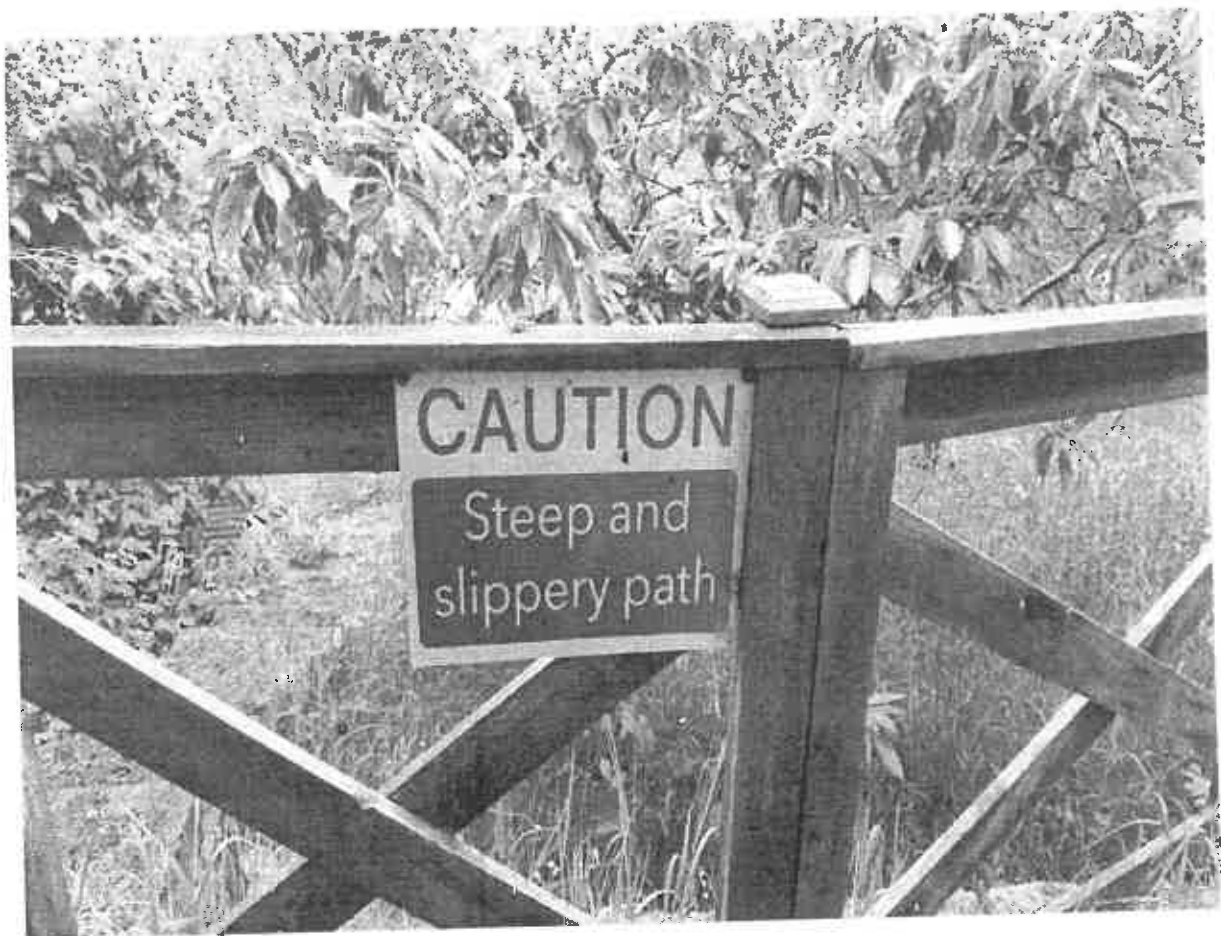

Bilingual signage – £500 budget
We will obtain the best quote we can for this from local sign makers

Appendix 2.8



Make good the shipping container roof with 'profile sheets that can be laid on top to stop water ingress.

£280inc VAT

<https://lpccladding.co.uk/>

Appendix 2.9



Repaint the shipping container with environmentally friendly metal paint

Brunswick Green £135 inc VAT, paint sundries £65 = total £200

<https://premiumpaints.co.uk/products/everest-trade-skip-and-container-paint-high-performance-machine-enamel-oxide-gloss>

Appendix 2.10



2 x qgarden garden trolley 1150mm x 515mm x 210mm

£179.98 (Two trolleys at £89.99 per unit)

<https://www.screwfix.com/p/qgarden-garden-trolley-1150mm-x-515mm-x-210mm/4720x>

Appendix 2.11



4 x walsail easiload puncture-proof wheel wheelbarrow galvanised 85ltr

£239.92 (Four Wheelbarrows at £59.98 per unit)

<https://www.screwfix.com/p/walsail-easiload-puncture-proof-wheel-wheelbarrow-galvanised-85ltr/58532>

Appendix 2.12

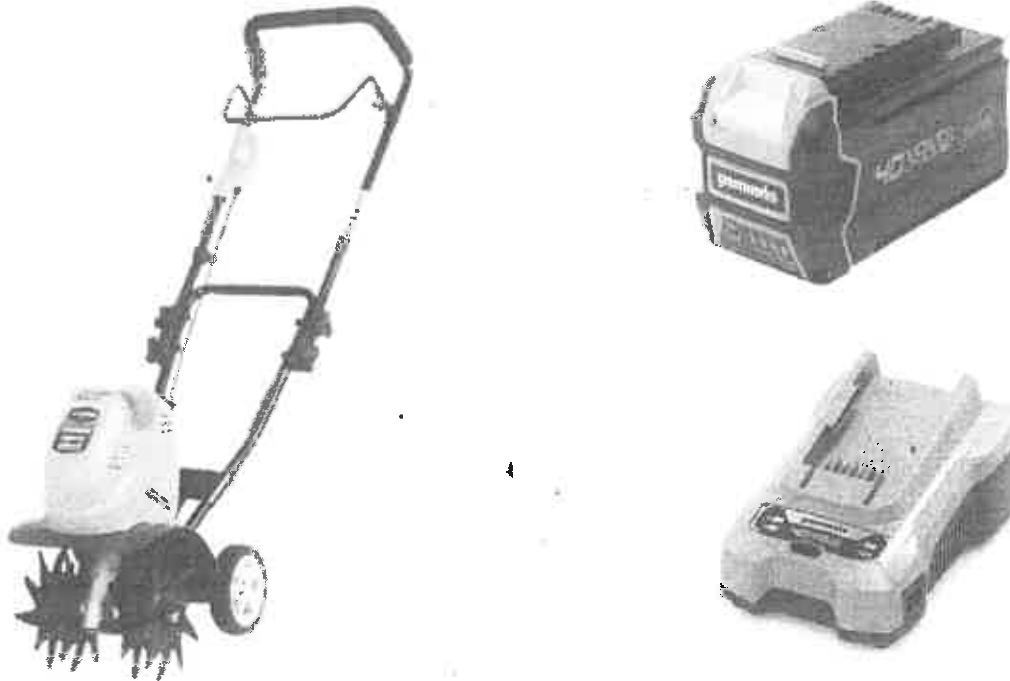

Cordless Cultivator (Cultivator, charger and 2 batteries)
£585.96

- **Greenworks gwg40tl 25cm 40v li-ion cordless cultivator - bare**
£201.99
<https://www.screwfix.com/p/greenworks-gwg40tl-25cm-40v-li-ion-cordless-cultivator-bare/950kt>
- **Greenworks gwg40b4 40v 4.0ah li-ion battery**
Two batteries £164.99 x 2 = £329.98
<https://www.screwfix.com/p/greenworks-gwg40b4-40v-4-0ah-li-ion-battery/847ht>
- **greenworks gwg40c 40v li-ion charger**
£53.99
<https://www.screwfix.com/p/greenworks-gwg40c-40v-li-ion-charger/782ht>

Appendix 3: Project Costs

A. Apiary costs met by Adam Street Allotment Association

Living wage £13.07/hr

- Making Frames 5 hours; $£13.07 \times 5 = £65.35$
- Book keeping 4 hours; $£13.07 \times 4 = £52.28$
- Cleaning equipment 7 hours; $£13.07 \times 7 = £91.49$
- Cleaning extraction shed 7 hours; $£13.07 \times 7 = £91.49$
- Feeding and Hefting 5 hours; $£13.07 \times 5 = £65.35$
- Extraction 20 hours; $£13.07 \times 20 = £261.40$
- Jarring and Labelling 20 hours; $£13.07 \times 20 = £261.40$
- Selling 15 hours; $£13.07 \times 15 = £196.05$

Apiary total = £1082.81

Miscellaneous costs met by Adam Street Allotment Association

Living wage £13.07/hr, Professional welder wage £43.76/hr

- Skilled Welder 5 hours; $£43.76 \times 5 = 218.80$
- Painting shipping container 7; $£13.07 \times 7 = £91.49$
- Erecting 11 sheds (two person work), 35 hours per person = 70 hours; $£13.07 \times 70 = £914.90$

Miscellaneous total £1225.19

Total project costs met by Adam Street Allotment Association
Sub Total £2165.62

B. N/A

C. Funding requested from ALCC Solar Farm Grant

£4750 10 x 6x4ft sheds
£107.98 Padlocks
£950 Apiary shed 1 x 6 x 12ft shed
£2277.80 Caillas uncapping machine – Delivered
£1452 Honey extractor – Delivered
£470 10 x compost bins – delivered
£500 Bilingual signage - budget
£280 Profile sheets for shipping container roof?
£200 Paint and Sundries
£179.98 2 x garden garden trolley 1150mm x 515mm x 210mm
£239.92 4 x walsall easiload puncture-proof wheel wheelbarrow galvanised 85ltr
£585.96 Cordless Cultivator (Cultivator, charger and 2 batteries)

Sub Total £12023.64

Total project costs (A+B+C)
£14189.26

Appendix 4:

How does your project deliver the seven well-being goals in the Well-being of Future Generations (Wales) Act 2015, namely:

1. A Prosperous Wales
2. A Resilient Wales
3. A Healthier Wales
4. A more equal Wales
5. A Wales of cohesive communities
6. A Wales of vibrant culture
7. A globally responsible Wales

The Adam Street Regeneration Project

1. A Prosperous Wales

The Adam Street Regeneration Project is deeply rooted in the vision of fostering prosperity and sustainability within our community. Honey sales serve as more than just financial transactions; they represent a commitment to reinvesting in the improvement of our allotment's facilities. Through the dedication of our volunteers, we've upheld the integrity of the allotments and apiary, ensuring they remain vital assets to our community. The revenue generated from honey sales is strategically channelled back into the allotment, facilitating continual enhancements. We prioritize collaboration with local businesses, advocating for the sale of honey at affordable prices to benefit both consumers and enterprises. By maintaining competitive retail prices, we guarantee that the local community reaps tangible benefits. Our bee project stands as a testament to longevity and legacy, playing an integral role in sustaining the allotment project. For over 70 years, our allotment has been more than just a site for food cultivation; it's been a platform for various community endeavours. Embracing the principles of a circular economy, the revenue generated from honey sales bolsters the allotment's financial stability. As a result, we've managed to keep plot fees low while securing comprehensive insurance coverage, ensuring the sustainability of our endeavours. The Apiary, now in its 14th year, symbolizes our enduring commitment to community prosperity and environmental stewardship.

2. A Resilient Wales

Our approach to ecological resilience is multifaceted, underpinned by a commitment to nurturing wildlife and safeguarding vital ecosystems. The Adam Street allotment serves as an oasis for diverse flora and fauna, meticulously cultivated by our dedicated volunteers. Through the creation of various habitats, such as ponds, wildflower areas, and orchards, we've fostered an environment where wildlife thrives. Companion planting techniques and thoughtful cultivation practices help maintain a delicate ecological balance, promoting pollination, disease prevention, and pest control. The apiary, a cornerstone of our project, plays a pivotal role in supporting local biodiversity by facilitating the pollination of food crops and nurturing wild plant species. Our dedication to ecological resilience extends beyond our immediate community, contributing to the broader environmental health of Wales.

3. Healthier Wales

Food holds significant cultural importance in Wales, and The Adam Street Regeneration Project champions healthy eating habits through sustainable food production. Our allotment project

promotes a vegetable-led diet, emphasizing the value of locally sourced produce. Collaborative partnerships with organizations like Pentref Tyleri, Blaenau Gwent Food Partnership, and local schools facilitate educational workshops and wellbeing initiatives. These efforts empower individuals to make informed dietary choices, promoting holistic well-being within our community. By providing access to nutritious, seasonal food, we strive to improve the health outcomes of residents in Abertillery and Blaenau Gwent. Our commitment to health and wellness extends beyond the allotment, influencing broader community attitudes towards food and nutrition.

4. A More Equal Wales

Inclusivity lies at the heart of The Adam Street Regeneration Project, ensuring that all community members have equal access to opportunities. Through the provision of accessible raised beds and wheelchair-friendly plots, we strive to create an inclusive environment for all. Our commitment to fostering a sense of belonging and empowerment transcends socioeconomic barriers, creating a more equitable and inclusive community. By valuing the contributions of every individual, we seek to bridge divides and promote unity within our diverse community.

5. A Wales of Cohesive Communities

Adam Street Community Allotments serve as a vibrant hub for intergenerational skill-sharing and community engagement. From responsible food growing to wildlife conservation, our allotment provides opportunities for people from all walks of life to connect and learn together. By fostering a sense of camaraderie and shared purpose, we create cohesive communities where everyone can participate and contribute. Our commitment to community cohesion extends beyond the allotment, fostering collaboration and unity across Abertillery and Blaenau Gwent.

6. A Wales of Vibrant Culture

The Adam Street Regeneration Project celebrates Wales's rich culinary traditions and cultural heritage. Through the preservation and promotion of allotment gardening, we honor the legacy of our ancestors and their commitment to self-sufficiency. Bilingual signage reflects our dedication to promoting Welsh language and culture, ensuring that our heritage remains accessible to all. By educating and engaging community members, we inspire a deeper appreciation for our cultural traditions and environmental stewardship. Our efforts to preserve Welsh culture resonate beyond our community, influencing broader attitudes towards tradition and heritage.

7. A Globally Responsible Wales

Through collaboration and knowledge-sharing, The Adam Street Regeneration Project makes a positive contribution to global well-being. By teaching the art of beekeeping and promoting environmental stewardship, we empower individuals to make a difference in their communities and beyond. Revenue from honey sales sustains local initiatives while supporting global efforts to combat food insecurity. Our partnerships with organizations like the Blaenau Gwent Food Partnership and donations to the Ebenezer Food Bank extend our impact beyond our immediate community, fostering a more equitable and sustainable world for all.

Appendix 5:

Adam Street Community Allotments Association

Constitution

1. Name

The Association is named **Adam Street Community Allotments Association** (The Association).

a. Administration

Subject to the matters set out below the Association and its property shall be administered and managed in accordance with this Constitution by the officers and members of the Committee.

2. Objectives

The objectives of the Association ("the objectives") are:

- a. To promote the interests of all members in their gardening activities, and to take joint action for the benefit, and protection of members.
- b. To maintain harmonious and productive relationships with our land owner (Mrs E.Dyk [REDACTED] ent), and the organisation they sub-let to (The Community Council of Abertillery & Llanhilleth, Mltre Street, Abertillery, Gwent, NP13 1AE).
- c. To promote a sense of vibrant community; to be socially inclusive; to value sustainability; to have regard for environmental protection; to value biodiversity; to promote open communication.
- d. To promote the sharing of knowledge about gardening and allotment management in order to promote success in our core task of growing vegetables, flowers and fruits.
- e. To manage the allotment site to ensure it is safe, well-maintained, accessible and friendly place to be.
- f. To agree policies relating to the administration and management of the site, including self-management and greater tenant involvement.
- g. Secure funding for the allotment's development, maintenance and services through tenancies, subscriptions, grants and fundraising.
- h. To promote and introduce more children and young people to allotment gardening.
- i. To promote education opportunities and practical workshops for tenants, schools and local residents.
- j. To encourage biodiversity and conservation through sustainable and green practices, such as recycling, composting, water efficiency and protecting wild-life habitats through organic cultivation.

3. Aims

The aims of the Association ("The Aims") are:-

- a. To establish and maintain a democratically elected and representative Committee of Management to facilitate and develop the Associations Objectives.
- b. To promote allotments for members and encourage members to keep their allotments in cultivation and weed free.
- c. To encourage a high standard of vegetable, flower and fruit cultivation.
- d. To assist members by providing water butts, toilets, a community hut and community greenhouse.
- e. To encourage an interest in organic gardening.
- f. To encourage members to value wildlife in their allotments.
- g. To provide good relationships with the local community by providing plots for specific Community Groups and maintaining a fair waiting list system for new allotment holders.
- h. To improve access for people with disabilities.

4. Powers

In furtherance of the objectives the Association may:-

- a. Co-operate with other organisations (charities, voluntary bodies and statutory authorities) and exchange information and advice.
- b. Take such steps that have been agreed with the Local Authority which are necessary for the good management and cultivation of the allotments.
- c. Raise funds by any lawful means except permanent trading.
- d. Accept gifts for the general purposes of the Association or for a specific purpose within or connected with the Objectives,
- e. Do anything within the law that is necessary in carrying out the Objectives.

5. Memberships and Subscription

- a. Every member shall pay an annual subscription of such amounts as the committee decides and from time to time. The annual subscription is due on the 1st January each year. (The year runs from January to December).
- b. Any member who is in arrears 4 weeks following the subscription date (1st January) will cease to be a member and will lose their plot/s.
- c. The Committee shall have the right for good and sufficient reason to terminate the membership of any member.
- d. A member whose membership is so terminated shall have the right to appeal to the Complaints Panel, which will consist of the senior elected members of the Committee (Chairman, Vice-Chairman, Secretary or Treasurer).

- e. Where the Complaints Panel is satisfied after hearing the case put or on behalf of the member concerned that the member should leave the Association, it may terminate that membership by written notice and that notice is final.
- f. A member may resign their membership at any time.
- g. The Committee must keep a full list of members.

5.2 Subscriptions

- a. Every member shall pay an annual subscription of such amounts as the committee decides from time to time. The annual subscription is due on the 1st January each year. (The year runs from January to December).
- b. Any member who is in arrears 4 weeks following the subscription date (1st January) will cease to be a member and will lose their plot/s.
- c. Any member who is arrears without good cause 4 weeks following the subscription date shall cease to be a member.

6. Annual and Extraordinary General Meetings

6.1 Annual General Meetings (AGMs)

There must be an AGM of members of the Association every calendar year in April. At the AGM members will:-

- a. Receive the Chairman's report for the previous year.
- b. Receive the Treasurer's report and accounts for the previous year.
- c. Elect the Officers and Committee for the following year.
- d. Elect a person who shall act as auditor by undertaking a review of the financial records of the Association.
- e. Determine any other matter of which notice has been given or which members wish to raise.
- f. At least 14 days notice shall be given to all members before each AGM.

6.2 Extraordinary General Meetings (EGM's)

- a. EGM's may be held at any time if called by a Committee or if at least ten members of the Association make such a request to the Committee. An EGM should be called at the earliest reasonable opportunity.

6.3 Procedure at AGM's and EGM's

- a. A General Meeting requires at least 14 days notice to the members specifying the matters to be dealt with by way of Agenda.
- b. The Chairperson or Vice Chairperson of the Committee or in their absence another Committee member elected by the meeting, will take the chair at General Meetings.
- c. Every question is decided by a majority of the votes cast if appropriate. In the case of equality of votes the Chairman has the casting votes.

7. The Management Committee

7.1 The Composition of the Committee

- a. The Committee is the body responsible for the management of the Association.
- b. The Committee has the power to make rules for the administration of the Association.
- c. The Committee shall consist of a minimum of five and a maximum of twelve members.
- d. The Officers and members of the Committee are elected annually at the Annual General Meeting (Each individual wishing to stand should have a proposer and seconder) and normally hold office until the end of the AGM the following year.
- e. A member of the Committee who resigns by written notice to the Committee ceases automatically to be a member of the Committee.
- f. The Committee has a duty to ensure that all decisions taken are in the best interests of the membership.
- g. Only members of the Association may be eligible to stand as Committee members.
- h. The Committee should:
 - *Have a shared sense of purpose (following aims & objectives)*
 - *Provide direction and leadership*
 - *Take collective responsibility*
 - *Deal with compliance issues*
 - *Be accountable to the members of the Association*

7.2 Officers of the Society

- a. The Officers of the Association will be the Chairperson, Vice-Chairperson, Secretary and Treasurer.
- b. These Officers will be elected by majority at the AGM.

7.3 Committee Procedures

- a. The Committee should try to meet at least four times in every calendar year. A special meeting of the Committee may be called at any time on 7 days notice. (A quorum at Committee meetings is 3)
- b. Every question is decided by a simple majority of the Committee members present and voting at a meeting. In the case of equality of votes the Chairperson of the meeting has the second casting vote.

- c. The Secretary or nominated Committee member must keep minutes of its meetings and proceedings and keep safe all records relating to the Association.
- d. The Committee may make rules to govern its own proceedings so long as they are not inconsistent with the provisions of the constitution.

7.4 Committee Nominations

- a. Members of the Committee are eligible for re-election and those wishing re-election should be confirmed before the AGM.
- b. New candidates who wish to be nominated for election to the Committee shall make themselves known to the Chairperson at least 14 days prior to the AGM. Each nomination should be proposed and seconded.

8. Finance

- a. All funds belonging to the Association may only be used in furthering the Objectives.
- b. The Treasurer shall maintain an account for the Association at a Bank or Building Society and make regulations governing the signatories (of which there must be at least two) on such accounts. All monies received by the Association shall be held in this account.
- c. No member of the Committee shall receive any payment or other benefit from its funds except for reasonable out of pocket properly incurred for the purposes of the Association.
- d. The Treasurer is responsible for the keeping of books of account and for the preparation of an Annual Report and Annual Statement of Accounts for the Association. A balance sheet showing the Associations previous years accounts should be presented at the AGM.
- e. The accounts shall be audited at least once a year by the auditor appointed at the AGM.
- f. The financial accounts of the Association are to be open to inspection by any member on request.



9. Amendment of the Constitution

- a. The provisions of the Constitution may be amended at an Annual General Meeting. The amendment should be put in writing with proposer and seconder from the elected committee and be in the possession of the Secretary at least 21 days prior to the AGM.
- b. Notice of terms of the proposed amendment must be given with the notice calling for the meeting.
- c. No amendment may be made which would have the effect of making the Association cease to comply with legal requirements or applicable by-laws or Council regulations.
- d. No amendment may be made to the name of the Association and the Dissolution clause.

10. Dissolution

- a. The Association may be dissolved at the General meeting by resolution passed by a simple majority of members present. (21 days notice stating the terms of the proposed resolution shall be given to every member of the Association).
- b. In the event of dissolution the members of the committee holding office will remain responsible for the orderly winding up the affairs of the Association.
- c. After paying or making provisions for all debts and liabilities of the Association the Committee shall transfer remaining assets to Charitable Institution or Community Organisations, having similar objectives to the Association.

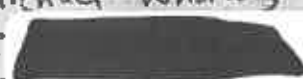
Authorised Signatures Confirming 'Constitution':

Chairman: Name - JOHN WATKINS Signature - 	Date - 8-7-23
Secretary: Name - Michael Whalley Signature - 	Date - 14/08/23
Treasurer: Name - SUE PRICE Signature - 	Date - 17/10/23

ALCC ClerkMailbox

From: ingrid sourbutts
Sent: 04 June 2024 13:56
To: ALCC ClerkMailbox
Subject: Re: Solar Farm Grant Application

Dear Erika,
Thank you for getting back to me !
The bank account details are
Adam Street Community Allotments Society
Acc no [REDACTED]
Sort cc [REDACTED]
It is Nat West Bank and it is not a business account.
I hope you can include this for me please and please accept my apologies for missing it out!
Yours, Ingrid Sourbutts

On 4 Jun 2024, at 12:09, ALCC ClerkMailbox <clerk@abertilleryandlanhilleth-wcc.gov.uk> wrote:

Good afternoon Ingrid

Thank you for completing and returning your Solar Farm grant application. We need clarification on a few points and some further information before we can pass the application to Council.

1. Please supply your bank details. Account name, sort code and account number. Is this a business account?

We would be grateful if you could inform us of this information as soon as possible

Kind regards
Erika Davies
Deputy Clerk
Phone | Ffon: 01495 217323
Website | Gwefan: <http://www.abertilleryandlanhilleth-wcc.gov.uk>
Council Offices, Mitre Street, Abertillery, Blaenau Gwent, NP13 1AE

Swyddfeydd y Cyngor, Heol Mitre, Abertylen, Blaenau Gwent, NP13 1AE

This email has been scanned for spam & viruses. If you believe this email should have been stopped by our filters, [click here](#) to report it.

Abertillery and Llanhilleth Community Council (ALCC)

Solar Farm Grant 2024 – Application

(see criteria and process attached before applying)

Name and Address of your group or organisation:

Abertillery Bowling Club & Abertillery Cricket Club
The Pavilion
Abertillery Park
Abertillery
NP13 1TU

Contact name: Richard Cook

Role in group: Secretary

Telephone number: [REDACTED]

Email: [REDACTED]

What is the name of your project?

Y Pafiliwn (The Pavilion) – Replacement of exiting Roof structure to prevent water ingress and safeguard its structure.

What are the aims of the project?

Background

In March 2024 the Cricket Pavilion at Abertillery Park was condemned by the Local Authority due to its dilapidated condition and dangerously high levels of asbestos within its structure. With no changing or toilet facilities there was a real prospect of no cricket being played in the town for the first time in 153 years.

Abertillery Bowling Club were determined this would not happen and allowed the use of their facilities at no cost to the Cricket Club. Despite its challenges (having two changing facilities and four teams playing!) a positive relationship was established to benefit sport in Abertillery.

The old Cricket Pavilion is scheduled for demolition later this year, whilst temporary demountable cabins (changing rooms) will be installed and ready to use during mid-June. The present situation has presented a perfect opportunity to create a first-class welcoming facility at Abertillery Park.

The current bowling pavilion is located in the heart of Abertillery Park and was constructed in 1984 and poses obvious challenges.

- Current Pavilion roof has failed on numerous occasions, water damage to ceiling, flooring and electrics has been sustained in numerous areas throughout the facility.
- The current Pavilion has no heating source – this has a detrimental effect on the internal fabric of the building and its furnishings. Most importantly, this prevents the use of the facility during the winter period, effecting the sustainability of the club.
- Wooden windows and doors are not energy efficient, uneconomic.
- Lighting requires upgrading to energy efficient LED.
- No disabled toilet facility.
- Current internal design is made up of small rooms, over 65% of the footprint is Changing and toilet facilities. Our data shows that changing facilities are used for less than 19 minutes on a match-day.

Y Pafiliwn (The Pavilion)

Abertillery Bowling Club and Abertillery Cricket Club share the ambition of creating a multi-functional community and well-being space using the existing footprint of the current bowling pavilion.

Dual purpose facilities are encouraged by major funding bodies such as Sport Wales, ECB (English Cricket Board) and WG Community Facilities Programme. The obvious sustainability benefits are looked upon more favourably during the grant process.

To protect the immediate future of the building we are proposing 'The Solar Farm Grant' funds the replacement of the existing roof, fascia/soffits and guttering. This is crucial before we commence the following phased approach:

Phase One – Replacement of existing Roof, safeguarding the current structure (Fund: Solar Farm Grant, *application submitted*)

Phase Two – Installation of Solar Panels, Battery Storage and replacement of existing wooden windows (Fund: Sport Wales, *application submitted pending phase one approval*)

Phase Three – Single story extension to accommodate two changing rooms and shower facilities (Fund: English Cricket Board, Welsh Government Community Facilities Programme and Levelling-Up Fund. *Architecture plans drawn, pre-planning application submission July 2024*)

Phase Four – Creation of a car park using the location of the existing Cricket Pavilion site. Creating an inclusive environment by improving access for the disabled and elderly (National Lottery Awards for All Wales).

Please note we are already working in association with GAVO, Sport Wales, ECB, Bowls Wales and Blaenau Gwent CBC to deliver this joint project.

How will your project benefit the Abertillery and Llanhilleth area or its residents?

Abertillery Bowling Club are the only club in the area that provides the opportunity for Men's, Ladies and Junior bowls. We proudly have one of the oldest established Ladies Teams in Wales.

Abertillery Cricket Club are the only Cricket side in the Community Council area, proudly providing the opportunity to play cricket for all the community!

Approximate number of beneficiaries
2000 Adults and Children

What will be delivered as a result of the Solar Farm Grant?

- Installation of a new Westerland Slate roof, new ridges and dry ridge kits
- New fascias, guttering soffits and downpipes in UPVC Anthracite grey.

Project costs:

A. Project costs met by your group	Amount (Inc. VAT)
Replacement of all Internal ceilings (plaster boards and skim)	£ 6,725.00
	£
	£
Sub Total	£ 6,725.00

B. Funding being provided by other organisations	Amount (inc.VAT)
Solar Panels, Battery Storage and Replacement of all Windows using UPVC Triple Glazed A++ windows	£ 25,000.00
	£
	£
Sub Total	£ 25,000.00
C. Funding requested from ALCC Solar Farm Grant	Amount (inc.VAT)
New Westerland Slate Roof	£ 27,790.00
New fascias, guttering soffits and downpipes in UPVC Anthracite grey	
Sub Total	£ 27,790.00
D. Total project costs (A + B + C) TOTAL	£ 59,515.00

How will your project improve the local environment?

Abertillery Bowling Club and Abertillery Cricket Club are committed to help make Abertillery Park a vibrant place for sporting organisations, visitors and our community.

Past partnerships with National organisations has helped improve the biodiversity of our area, creating wild flower beds and community growing areas. In association with Keep Wales Tidy volunteers from both clubs complete weekly litter picks of Abertillery Park. During April in association with Natural Resource Wales and Gwent Wildlife Trust we completed the cleaning of the River Ebbw over a three day period.

How does your project contribute to sustainability?

Abertillery Cricket Club run a First XI, Second XI and Ladies Toucans. They also provide the opportunity of cricket to local children via the ECB All Stars Cricket and Dynamos Cricket programmes.

Abertillery Bowling Club run three Men's teams, Ladies Team and one Mixed Team. We also run the most successful 'KidsBowls' programme in the UK (Bowls International Magazine).

By both clubs sharing one facility it will create a sustainable and vibrant facility, fit for the 21st Century. Better facilities equal better clubs! Both clubs will have the opportunity to grow membership and increase revenue.

The current facilities at Abertillery Park needs drastic improvement to stem the increased movement of local players to clubs in neighbouring towns who have better facilities. Currently this is the major factor in preventing club growth.

How does your project link with local schools?

Abertillery Bowling Club and Abertillery Cricket Club actively promote Bowls and Cricket in local Schools in conjunction with Abertillery 3-16 Learning Community and Aneurin Leisure Trust Sports Development Team.

How does your project promote volunteering?

Both the Cricket and Bowling club are run by volunteers from the Community. The preparation of the Cricket Wicket and Bowling Surface are lovingly prepared by volunteers.

All grass verges, hedges and flower beds are also maintained by club volunteers. Weekly litter picks are also completed by the club.

How does your project promote links between communities?

Abertillery Bowling Club and Abertillery Cricket Club work closely with 3-16 Learning Community, Coleg Gwent, Aneurin Leisure Sports Development Team. We also maintain close links with other community groups and sports organisations.

How does your project help deliver the seven well-being goals in the Well-being of Future Generations (Wales) Act 2015, namely:

- A prosperous Wales
- A resilient Wales
- A healthier Wales
- A more equal Wales
- A Wales of cohesive communities
- A Wales of vibrant culture
- A globally responsible Wales?

Our project helps deliver the seven well-being goals in Wales:

A prosperous Wales – Our project is aimed at creating more prosperous and sustainable clubs, that the community wants to join and play.

A resilient Wales – By maintaining the cricket wicket, outer field and bowling surface

we are helping to support eco systems within the land. All products used on these surfaces are environmentally friendly and will not harm any wildlife or habitats.

A healthier Wales – Abertillery Bowling Club and Abertillery Cricket Club plays an integral part to the mental, physical health and well-being of our community. We proudly encourage physical activity for people of all ages in our community.

A more equal Wales – Abertillery Bowling Club and Abertillery Cricket Club run a total of ten sides at Abertillery Park including Mens, Ladies and Junior teams, providing the opportunity to all the community!

A Wales of cohesive communities – Bowls and Cricket allow people of all ages, abilities, gender and of any background to participate in our sport. Bowls in particular provides unique intergenerational opportunities in a community, there are no age or physical barriers to participation.

A Wales of vibrant culture – Abertillery Bowling Club was established in 1911, Abertillery Cricket was established in 1871, both clubs have played a vital role in our communities' history and central to the health and well-being of our residents. We want to play a positive role in our town's future.

A globally responsible Wales – Abertillery Bowling Club and Abertillery Cricket Club are passionate about working with local companies and reducing our Carbon footprint. By August 2024 we aim to operate battery powered Greens Maintenance Machinery and produce our own energy using sustainable methods. With Sport Wales grant submitted for the installation of Solar Panels to the Pavilions roof, we remain confident that the building will be solely powered by sustainable energy.

If funding is granted, what will successful delivery of the project look like?
A shared, 'sustainable' and vibrant community facility.

Will you (and when will you) supply completion reports / evidence / photos?
Upon notification of funding award we aim to complete the roof replacement within five months. A project manager will be appointed, they will be responsible for submitting a project completion report, this will include photographs and evidence of spends. Both Clubs will also actively promote the use of this fund via our Social Media Channels (Facebook, Instagram and X).

Is your organisation a: Charity/community group/sports club/company/not for

profit business/other (explain and provide evidence)

Sports Club & Not for Profit organisation

Payee name: **Abertillery Bowling Club and Abertillery Cricket Club**

Signed:



Print Name: **Richard Cook**

Date: **27/05/2024**

This form must be submitted with any relevant supporting documents you wish to submit (e.g. business plan, group constitution, bank or financial statements, letters of support etc) to Abertillery and Llanhilleth Community Council by Friday 31st May 2024, either by post to Town Clerk, Abertillery and Llanhilleth Community Council, Mitre Street, Abertillery, NP13 1AE or email clerk@abertilleryandllanhilleth-wcc.gov.uk.

Abertillery and Llanhilleth Community Council (ALCC)

Solar Farm Grant 2024 – Application

(see criteria and process attached before applying)

Name and Address of your group or organisation:

Abertillery Excelsiors AFC, Jim Owen Field, Cwmtillery, Abertillery, Gwent, NP13 1LW

Contact name: Matthew Thomas

Role in group: Club Secretary

Telephone number: [REDACTED]

Email: [REDACTED]@com

What is the name of your project? Community Space at the Jim Owen Field

What are the aims of the project? The aim of the project is to provide a new community space located at the Jim Owen Field Cwmtillery. The space will provide opportunities for local people to develop new skills and opportunities for employment through Pantref Tyleri. The project also aims to bring in new sports around the area such as mountain biking changing facilities and secure storage along with the development of the female football game by developing the existing changing rooms.

The specifics of this grant application will allow us to place fees towards the cost of the design and planning fees associated with the proposed development.

How will your project benefit the Abertillery and Llanhilleth area or its residents? The project will provide space for the community to develop and learn new skills, provide opportunities for employment via Pantref Tyleri. Include community activities such as:

- healthy cooking workshops
- producing meals on a budget,
- workspace for textiles and carpentry

- space for flexible working, to hold meetings, work etc
- hosting of training sessions such as first aid, coaching development
- Area to hold youth clubs/playgroups
- Changing area and showers for cyclists/mountain bikers to utilise due to the close proximity of the mountainous area and local lake.
- Ability to hold female matches with upgraded changing rooms and individual cubicles
- DDA compliant accesses

These activities will help to upskill local people and provide an area to be enjoyed and used by the community.

In addition, our architects have volunteered their time in assisting to train local people with new skills in carpentry and joinery.

Approximate number of beneficiaries: Once completed the new space has the potential to benefit in excess of 2000 thousand people.

What will be delivered as a result of the Solar Farm Grant? The Solar Farm Grant will provide the funding to assist with the initial design costs, planning application and surveys and site investigation works.

Project costs:

A. Project costs met by your group	Amount (inc. VAT)
	£2000
	£
	£
Sub Total	£2000
B. Funding being provided by other organisations	Amount (inc. VAT)
Blackwood Engineering Trust (awaiting)	£2000
GAVO (awaiting) (planned for June 24)	£2000
Coalfields Regeneration Trust (planned for June 24)	£2000
FAW Facilities Grant (application planned for October 24) (Build, tender and contract fees)	£250,000
Community Facilities Grant (EOI planned for August 24) (Build, tender and contract fees)	£100,000

	Sub Total	£361,000
C. Funding requested from ALCC Solar Farm Grant		Amount (inc.VAT)
		£6000
		£
	Sub Total	£6000
D. Total project costs (A + B + C)	TOTAL	£369,000

How will your project improve the local environment?

In terms of the social element the space will provide an area for the local community to meet, hold events, develop and upskill. It will provide a base for other sports to be explored such as hiking, mountain biking, and development of the female football game in Wales.

In relation to the environment, the building will incorporate sustainable elements such as a green roof to provide habitats for the environment adding to the existing Natural Resources Wales projects that have already developed around the area.

How does your project contribute to sustainability? As part of the main construction elements of the project we will be looking to use sustainable materials wherever possible whilst incorporating a green roof which will provide habitats for small wildlife and develop biodiversity. This will continue to grow the current areas which have already been developed by Pantref Tyleri where alongside the existing pavilion is a wetland area which has been used by Natural Resources Wales as an Exemplar. The improvements required as part of the project will include a revamp of the existing boiler system to reduce running costs and potentially draw on solar power to run the new space.

How does your project link with local schools? The local schools within the area are aware of Abertillery Excelsiors, where circa 100 players currently play for the club. Our offering link players from the age of 5 up to 18 and then also provides opportunities for senior football. Pantref Tyleri run events for the local community which encourage young people to work on sustainable projects and develop their knowledge including planting trees etc within the local area.

How does your project promote volunteering? All committee members, coaches, managers, first aiders and the club safeguarding officer at Abertillery Excelsiors are volunteers. Coaches and managers undertake their qualifications in their own time and provide the opportunities for local people to become involved in a safe football environment from a young age.

How does your project promote links between communities?

Asset-Based Community Development (ABCD) is a methodology that focuses on leveraging existing community assets and strengths rather than focusing on deficiencies and needs. When linked to a grassroots football club, ABCD can be a powerful tool to enhance community engagement, build social capital, and foster local development. Identifying and Leveraging Community Assets is vital when promoting links with the community.

Human assets would include, players, coaches, managers who are all local volunteers. Social Assets would involve mapping the current community networks; leverage existing social networks to spread awareness about the club and the project, recruit new members, and foster a sense of belonging. Partnerships with local organisations, collaborate with schools, businesses, and other community organisations to create joint programs and initiatives.

Pantref Tyleri is a trusted partner who already provide a local café facility which local people can use during their opening hours, offering locally sourced food, coffee as well as providing a space for the local community to meet.

In addition, the new workshop space will aim to provide local people with opportunities to upskill and get involved in health cooking workshops, preparing balanced meals on a budget. Provide opportunities for training/upskilling.

Abertillery Excelsiors provide sporting opportunities for local people within the community to get involved in football from a young age. The proposed facility will also provide opportunities for hosting the female game at all levels with improved changing facilities as well as opportunities for other sports such as table tennis, pool/snooker, darts, mountain biking etc.

How does your project help deliver the seven well-being goals in the Well-being of Future Generations (Wales) Act 2015, namely:

- **A prosperous Wales**
- **A resilient Wales**
- **A healthier Wales**
- **A more equal Wales**
- **A Wales of cohesive communities**
- **A Wales of vibrant culture**
- **A globally responsible Wales?**

The Well-being of Future Generations (Wales) Act 2015 aims to improve the social, economic, environmental, and cultural well-being of Wales. A grassroots football club

can contribute significantly to these goals through various initiatives and activities. Here's how Abertillery Excelsiors via this project can help support the delivery of each of the seven well-being goals outlined in the Act:

1. A Prosperous Wales

The project will provide long term foundations to allow Abertillery Excelsiors and Pantref Tyleri to grow and provide an increase in its offering through additional training opportunities and offering new sports. Providing opportunities to the local community to learn new skills and develop personally as well as professionally.

- **Economic Opportunities:** Grassroots football clubs can create local jobs, from coaching to administrative roles. There will be an opportunity to coproduce with local businesses to generate wider economic opportunities.
- **Skill Development:** Offering training and educational programs via coach education opportunities will help develop skills that are transferable to other areas of life and work, thus enhancing employability.

2. A Resilient Wales

- **Environmental Awareness:** The club will continue to promote sustainability by implementing eco-friendly practices, such as recycling programmes and energy-efficient facilities.
- **Biodiversity and Green Spaces:** Maintaining well-kept playing fields and surrounding areas can enhance local biodiversity and provide green spaces for the community. Pantref Tyleri already provide support to the local community via their active Green Space programmes.

3. A Healthier Wales

The club will continue to ensure the local community have access to the facilities and programmes to support physical and mental health needs of its residents.

- **Physical Activity:** Regular football activities promote physical health and fitness among participants of all ages.
- **Mental Health:** Participating in team sports can improve mental health by providing social interaction, reducing stress, and fostering a sense of community.

4. A More Equal Wales

Allowing access to changing facilities to encourage participation in additional sports, hosting of the female football game to encourage growth of the game.

- **Inclusivity Programs:** The club will ensure participation from diverse groups, including women and Girls.
- **Affordability:** Offering affordable membership and programmes ensures that football is accessible to people from all socioeconomic backgrounds.

5. A Wales of Cohesive Communities

Via this project, the club want to provide a community hub for locals to gather and meet. To host events and encourage community involvement such as tree planting, family fun days, healthy cooking ideas etc.

- **Community Engagement:** Clubs often act as community hubs, bringing people together through events, matches, and social activities.
- **Volunteering:** Encouraging volunteer work within the club promotes social cohesion and community spirit.

6. A Wales of Vibrant Culture and Thriving Welsh Language

Utilising local community groups to delivery cultural events linked to the local history of Cwmtillery, Abertillery and the surrounding areas.

- **Cultural Events:** Hosting cultural events and activities related to Welsh traditions and celebrations can promote and preserve local culture.
- **Welsh Language:** Promoting the use of the Welsh language in club activities, communications, and events.

7. A Globally Responsible Wales

- **Sustainable Practices:** Adopting and promoting sustainable practices within the club, such as reducing waste and lowering carbon footprints, contributes to global environmental efforts.

By integrating these initiatives Abertillery Excelsiors football club can play a pivotal role in advancing the well-being goals set forth by the Well-being of Future Generations (Wales) Act 2015, fostering a healthier, more sustainable, and cohesive society.

.....
(continue on a separate sheet if needed)

If funding is granted, what will successful delivery of the project look like?

Successful delivery of the funding provided by the Solar Farm Grant will include the approval of planning permission with developed plans to allow for the application of funding for the main capital build from the Football Association of Wales.

Will you (and when will you) supply completion reports / evidence / photos?
Evidence of reports and drawings can be provided as the scheme progresses through the design phase and eventual planning permission drawings. Finally, once the schemes progress to construction, we will provide photos of the build at various stages.

Is your organisation a: Charity/community group/sports club/company/not for profit business/other (explain and provide evidence)
Community Group and Sports Club

Payee name: Abertillery Excelsiors AFC

Signed:



Print Name: Matthew Thomas

Date: 15th May 2024

This form must be submitted with any relevant supporting documents you wish to submit (e.g. business plan, group constitution, bank or financial statements, letters of support etc) to Abertillery and Llanhilleth Community Council by Friday 31st May 2024, either by post to Town Clerk, Abertillery and Llanhilleth Community Council, Mitre Street, Abertillery, NP13 1AE or email clerk@abertilleryandllanhilleth-wcc.gov.uk.

ALCC ClerkMailbox

From: Matthew Thomas <[REDACTED]>
Sent: 10 June 2024 08:30
To: ALCC ClerkMailbox
Subject: Re: Solar Farm Grant Application

Hi Erika,

Hope your well. Just getting back to normal after the holiday, first day in work today.

In terms of what the £6000 will be used for, I can confirm it will be to help with the cost of the initial design fees, structural input and initial site investigation works. These works once complete in September will allow us to submit the project for planning permission.

Bank details are as follows :-

Abertillery Excelsiors AFC Ltd
Sort code - [REDACTED]
Account no [REDACTED]

We have a committee in place consisting of 12 people and 6 trustees. However the main management structure who form the committee and are also trustee members are:

- Chairman - Darren Britton
- Secretary - Matthew Thomas
- Treasurer - Roger Fisher

This step is the initial part of our project to get the design developed and submit to planning. Some of the other fees for the topographical survey has already been confirmed, this is circa £1500. GAVO funding we hope will provide monies for the actual planning fees themselves, however there are other options we are looking at and also fundraising ourselves. We are confident with the help of yourselves we would be able to get our project to planning stage. With regards to the other amounts, I am currently to liaising with the FAW Development officer who is guiding me through the requirements to make sure we tick off everything required to give us the best chance of getting the grant. He has a good level of confidence in us being successful. Similar for the £100k grant through the community programme. However if any of these big ticket grants are not successful we will look at other avenues such as the lottery etc. if we weren't successful in getting any of them though we wouldn't be able to progress with a build. Although as I have said we are confident we can get them.

On your final point, I can confirm we haven't had any funding from the Solar Farm Grant in the last 5 years.

If you require anything further, please let me know.

Thanks for considering our application.

Regards
Matthew

On Wed, 5 Jun 2024 at 12:32, ALCC ClerkMailbox <clerk@abertilleryandlanhilleth-wcc.gov.uk> wrote:

Hi Matthew

Yes, that's fine. Enjoy your holiday.

Erika

From: Matthew Thoma.
Sent: 05 June 2024 11:29
To: ALCC ClerkMailbox <clerk@abertilleryandlanhilleth-wcc.gov.uk>
Subject: Re: Solar Farm Grant Application

Hi Erika,

Thanks for the message.

Abertillery and Llanhilleth Community Council (ALCC) Solar Farm Grant 2024

– Application (see criteria and process attached before applying)

Name and Address of your group or organisation: St Illtyd Ministry Area,

Contact name: Fr Dominic McClean

Role in group: ...Ministry Area Leader.....

Telephone number: ... [REDACTED] ...

Email: [REDACTED]

What is the name of your project? St Michael's Church Abertillery Civic Church...

What are the aims of the project?

..... To enable the Church building to be
affectively used for the whole community...throughout the
year.....

How will your project benefit the Abertillery and Llanhilleth area or its residents?

St Michaels Abertillery, has a long history of engagement with the wider community, especially in terms of community events and engagement with a number of community based groups. Abertillery Band and 3 of the community choirs and the youth drama are all in support of this application. With the work the engagement of these groups, and the concerts they will put on over 2,000 residents from Abertillery and Llanhilleth will benefit from this project directly. And potentially 5,000 others who use the venue for funerals will also benefit over one year.....

Approximate number of beneficiaries7000

What will be delivered as a result of the Solar Farm Grant?

Sustainable Heating for the Church as a place of worship, and a community hub for Abertillery. As a community hub it will be a place of prayer and reflection, but it will also be developing St Michaels as a place that helps and sustains the musical culture of Abertillery, throughout the year. The two main things that are lacking in the Church building currently are public toilets and heating within the building. We will also be seeking to develop a social area within the church to provide food and drink to those who come to the church for community events within St Michaels.

Project costs:

A. Project costs met by your group Amount (inc. VAT) £ £ Sub Total £ £35,000 towards the cost of installing of two public toilets one being fully accessible,

B. Funding being provided by other organisations Amount (inc.VAT) £ £ Sub Total £10,000 towards the cost of installation of toilets, £5,000 from fundraising to building toilets that has been raised in the town in the past and in the last year by the local mayor fund

C. Funding requested from

ALCC Solar Farm Grant Amount (inc.VAT) This money will enable us to install a sustainable heating system.

£ Sub Total £ 25,000

D. Total project costs (A + B + C) TOTAL £ £75,000

How will your project improve the local environment?The project as a whole will provide a sustainable events space for in the very heart of the town, with an improved environment by the river side.....

How does your project contribute to sustainability?This part of the project will enable us to heat the building in an environmentally sustainable way with the use of ...efficient space heating methods.....

How does your project link with local schools? ...Currently we are engaging with the local schools, so that they can have better access to the church building, and engaging with the schools on new designs on the riverside garden which is part of the wider project of bringing life back to the church at the heart of the community.

How does your project promote volunteering? All the community groups that are already using the building are volunteer lead and we have been engaging with volunteer groups within Abertillery that want to make Abertillery a better place to live.

How does your project promote links between communities?.....

Not only will it enable choirs to engage with a wider public in Abertillery, they often bring choirs from outside of Abertillery to sing and play to the people of Abertillery. So by the nature of its usage It will bring different communities together.

How does your project help deliver the seven well-being goals in the Wellbeing of Future Generations (Wales) Act 2015, namely:

- **A prosperous Wales**

This project will attract people into the heart of town, on a more regular basis throughout the year. And as a consequence increase the foot fall around the town in the evening and during the day at weekends.

- **A resilient Wales**

It's a project that is not only about sustainability in terms of energy, but will strength the ability of the church to remain open to all in the future.

- **A healthier Wales**

By encouraging arts at the heart of the community it will encourage activities that give meaning to peoples lives and enable people to improve and maintain not only their physical health but also their mental health.

- A more equal Wales

- A Wales of cohesive communities

This project will enable different groups and ages to come together to celebrate the wonder that is the musical traditions of the Valleys in South Wales

- A Wales of vibrant culture

It will encourage and enable access to the vibrant musical traditions of the area.

- A globally responsible Wales?

Its purpose to make the the venue more accessible to all, by providing an accessible toilet, but considering the most affective heating system that can be net zero in the future.

(continue on a separate sheet if needed) If funding is granted, what will successful delivery of the project look like?

.....

Will you (and when will you) supply completion reports / evidence / photos? We will send a completion report with photos and other evidence on completion of this stage of the project. This will be by the end of 2025.

Is your organisation a: Charity/community group/sports club/company/not for profit business/other (explain and provide evidence)We are a church that is open to all without judgement, and count as a charity under the title of St Illtyd Ministry Area

.....

Payee name:St Illtyd MA.....

Signed:DJ McClean.....

Print Name: ...Fr D J McClean Chair of the Ministry Area.....

Date: ...7/05/2024.....

This form must be submitted with any relevant supporting documents you wish to submit (e.g. business plan, group constitution, bank or financial statements, letters of support etc)

to Abertillery and Llanhilleth Community Council by Friday 31st May 2024, either by post to Town Clerk, Abertillery and Llanhilleth Community Council, Mitre Street, Abertillery, NP13 1AE

or email clerk@abertilleryandllanhilleth-wcc.gov.uk



Dominic

St Michaels church

1 message

7 May 2024 at 10:34

Dear Father Dominic

On behalf of Cor Ebbw Fach we would like to say how much we appreciate you allowing us to use St Michaels church for our concerts. It is important to us and the other community groups that use it that it is warm and welcoming and we would very much support the installation of a heating system.

The community Christmas carol service was lovely but I am sure more people would have attended if it had been warm. Thank you again for supporting our community groups.

Please let us know if we can help with your bid

Best wishes

Lesley Angel

Secretary Cor Ebbw Fach

Sent from my iPad



Abertillery & Llanhilleth Community Council (ALCC)

To Whom it may Concern

Solar Farm Grants 2024

I am writing on behalf of the Abertillery Orpheus Male Choir. We are a non- profit community organisation that has previously applied for a Solar Farm Grant.

This year we have banded together with other Musical Societies in Abertillery, including choirs, operatic youth and adult societies and the Town Band, to ask that the Solar Grant be awarded to St Michael's Church, Abertillery, for the continued upgrading of the heating system and the installation of toilet facilities in the crypt area.

By supporting this bid from St Michael's we are not only supporting the community and local parish church, but we are also aware that any improvements to the facilities in St Michaels will have a knock on effect on the enjoyment of the local community and visitors attending our musical functions and concerts, including ALCC supported community events.

The Abertillery Orpheus Male Choir fully supports a bid from St Michael's Church, Abertillery, for funding through the Solar Farm Grants, to improve the heating systems and provide toilet facilities in the Church.

Phillip Tolley

Secretary

Abertillery Orpheus Male Choir

Tel: 07899 860351

www.abertilleryorpheus.co.uk

Supporting Letter for Church

2 messages

Abertillery Youth Drama and Music Society <aydms@outlook.com>

10 May 2024 at 05:53

Dear Father Dominic,

Please find my supporting email from AYDMS below.

ABERTILLERY YOUTH DRAMA AND MUSIC SOCIETY

To Whom it May Concern,

I write on behalf of Abertillery Youth Drama and Music Society in Support of St Michael's Church Abertillery regarding the Church's application to Abertillery and Llanhilleth Community Council, for a Solar Farm Grant, to purchase a new heating system.

AYDMS regularly sing at St Michaels in order to benefit the community at events organised by the ALCC such as the Christmas Concert and St David's Day concert. The recent performances have been performed in the Winter Months. The Congregations/Audiences have been depleted in these, due to the Church being extremely cold, despite the currently installed heaters being used for hours before the Services.

Our Organisation covers a total of 98 Members most of which are children. Our Supporters number is around 50 and regularly attend events in the Church too often commenting the same uncomfortableness attributed to the cold.

Please accept this letter as a supporting document for the Church's solar farm bid.

Sincerely
Hannah Webley
Director at AYDMS

Sent from my iPhone

Dominic McClellan · [redacted]
To: Abertillery Youth Drama and Music Society <aydms@outlook.com>

11 May 2024 at 10:16

Many thanks for this.
Fr Dominic McClellan
St Illtyd Ministry Area

[redacted]
[redacted] mail.com

[Quoted text hidden]



ABERTILLERY TOWN BAND

To Whom it May Concern,

I write on behalf of Abertillery Town Band in Support of St Michael's Church Abertillery's Application, to Abertillery and Llanhilleth Community Council, for a Solar Grant for a new heating system.

The Band regularly play in St Michaels, which we regard as one of the best Community Spaces in the Area. The recent concerts we have performed in at this Church, have been in the Winter Months, the Congregations have been depleted in the last few events due to the Church being extremely cold, despite the currently installed heaters being used for hours before the Services.

Our Organisation covers a total of 40 Members with a new Academy with around a further 10 members. Our Supporters number maybe 30 and regularly attend events in the Church too.

Sincerely

Nigel Bard

Chairman Abertillery Town Band

ALCC ClerkMailbox

From: Dominic McClean 
Sent: 10 June 2024 09:01
To: ALCC ClerkMailbox
Subject: Re: Solar Farm Grant Application

Dear Erika, in response to your questions, first apologies for not getting back earlier but I was away on a course so was not able to get back to you until now.

Question 1 Where is the £35,000 funding coming from, currently we have £5,000 in restricted funds for the toilets some from the majors appeal and the rest from legacy fundraising. The remaining amount will be a contribution from the sale of one of the churches in the ministry area. This building is about to go on the market on Sale.

Question 2 Bank Account details will be for the Ministry Area which has 9 churches and will be held as restricted funds for use only on this project, in Abertillery.

Branch Sort Code 

Account Number 

Lloyds Bank Name of Account St Illtyd MA

Yes we do have a Ministry Area Council and the office holders are

Currently I am the Chair, Fr Dominic McClean

Treasurer is Alan Jones

Secretary Hannah Daly

Safeguarding lead Deborah Cleaves

Ministry Area Warden Lynn Higgins

I hope that answers your questions if you have any more please let me know.

All the best

Fr Dominic

Fr Dominic McClean
St Illtyd Ministry Area
Y Rheithordy,
Maes Cwmbala

jm
tel 

Abertillery and Llanhilleth Community Council (ALCC)

Solar Farm Grant 2024 – Application

(see criteria and process attached before applying)

Name and Address of your group or organisation:

Celtic Pride Martial Arts

Contact name: Stephen Giffard

Role in group: Part owner / coach

Telephone number: [REDACTED]

Email: [REDACTED]

What is the name of your project?

Celtic pride community project

What are the aims of the project?

I have attached all the answers to the questions on a separate attachment

How will your project benefit the Abertillery and Llanhilleth area or its residents?

Approximate number of beneficiaries

What will be delivered as a result of the Solar Farm Grant?

Project costs:

A. Project costs met by your group	Amount (inc. VAT)
Purchase of the building	£ 69000
Regeneration work on the building	£ 50000
	£
Sub Total	£ 119000
B. Funding being provided by other organisations	Amount (inc.VAT)
	£
	£
Sub Total	£
C. Funding requested from ALCC Solar Farm Grant	Amount (inc.VAT)
	£ 20000
	£
Sub Total	£
D. Total project costs (A + B + C) TOTAL	£ 139000

How will your project improve the local environment?

.....

How does your project contribute to sustainability?

.....

How does your project link with local schools?

.....

How does your project promote volunteering?

.....

If funding is granted, what will successful delivery of the project look like?

.....
.....
.....
.....

Will you (and when will you) supply completion reports / evidence / photos?

.....
Yes, on completion of work.....
.....

Is your organisation a: **Charity/community group/sports club/company/not for profit business/other (explain and provide evidence)**

.....
Profit business.....
.....
.....

Payee name: Stephen Giffard.....

Signed:

Print Name: S Giffard.....

Date:

This form must be submitted with any relevant supporting documents you wish to submit (e.g. business plan, group constitution, bank or financial statements, letters of support etc) to Abertillery and Llanhilleth Community Council by Friday 31st May 2024, either by post to Town Clerk, Abertillery and Llanhilleth Community Council, Mitre Street, Abertillery, NP13 1AE or email clerk@abertilleryandllanhilleth-wcc.gov.uk.



Contents

Name and Address of Your Group or Organisation.....	2
Funding Contact	2
Name of the Project.....	2
Aims of the project.....	2
How will your project benefit the Abertillery and Llanhilleth area or its residents?	2
Approximate number of beneficiaries	2
What will be delivered as a result of the Solar Farm Grant?	3
Environmental Enhancements	3
Community Engagement.....	3
How will your project improve the local environment?	4
How does your project contribute to sustainability?	4
How does your project promote volunteering?	5
How does your project promote links between communities?	5
How does your project help deliver the seven well-being goals in the Wellbeing of Future Generations (Wales) Act 2015, namely:.....	6
A Prosperous Wales	6
A Resilient Wales.....	6
A Healthier Wales.....	6
A More Equal Wales.....	7
A Wales of cohesive communities	7
A Wales of vibrant culture & A globally responsible Wales.....	7
If funding is granted, what will successful delivery of the project look like?	8
Quarter 1.....	8
Quarter 2.....	8
Quarter 3.....	8
Quarter 4.....	8
Will you (and when will you) supply completion reports / evidence / photos?.....	9
Is your organisation a: Charity/community group/sports club/company/not for profit business/other (explain and provide evidence).....	9
Payee Details	9



Name and Address of Your Group or Organisation

Celtic Pride Martial Arts, 39 Somerset Street, Abertillery NP13 1DL.

Funding Contact

Sarah Morgan, Secretary.

Telephone number [REDACTED]

Email: [REDACTED]

Name of the Project

Celtic Pride Community Project (Working Title)

Aims of the project

- Environmental enhancements for our new premises at ADDRESS
- Furthering our engagement with our local community.

How will your project benefit the Abertillery and Llanhilleth area or its residents?

At Celtic Pride, we pride ourselves on the work we already do to support the residents of Abertillery and Llanhilleth and the surrounding areas. Not only do we provide a community for people looking to improve their health and fitness but learning a sport and competing can help young people and adults to grow their self-confidence and enhance their skill sets. Obtaining a Solar Farm Grant will allow us to extend our provision, ensure sustainability for the future, and lower our environmental impacts.

We will use the Solar Farm Grant to strengthen our community provision for young people and adults.

Approximate number of beneficiaries

Celtic pride has a community of over 100 members who attend weekly. The majority of these members are residents of Abertillery and the surrounding areas, however, some members also travel from further afield due to the excellent reputation of our gym.

We predict that our new community sessions have the potential to reach the following audiences:



- School Sessions: 30 children once a month
- SHEP Provision: 20 children, 5 sessions over the Summer.
- Emergency Services Sessions: 10 adults once a week.
- Women Only Sessions: 10 adults once a week.
- Quiet Sessions: 5 children once a month
- Events: 50 people x 4 events
- Community BBQ: 30 people.

In total, this project has the potential to reach 500 individuals in its first year. In subsequent years, we can increase our capacity for community events and community training sessions once we are established at our new premises and have recruited and trained more volunteers and trainers.

What will be delivered as a result of the Solar Farm Grant?

There are two themes for the project that will be delivered as a result of the Solar Farm Grant;

Environmental Enhancements

- Environmentally friendly design features that we will incorporate into our new premises such as more efficient heating systems and insulation. LIST OF DESIGN FEATURES FROM ARCHITECT. To do this, we will work with the architect for our new premises.
- Create appropriate facilities for recycling within the premises and signage to encourage members to use these facilities.
- Improve the surroundings of our new premises by planting native wildflowers in green areas and providing enhancements for wildlife such as bird and bat boxes and a log pile for invertebrates.

Community Engagement

- Events in local schools to teach children the basics of martial arts, improve their fitness, and have fun!
- Support Blaenau Gwent 'School Holiday Enrichment Projects' providing free, fun sessions to the most deprived children in our communities.
- Free sessions once a week for emergency service workers in Abertillery and Llanhilleth to learn self-defence and improve their fitness.
- Pilot the first 'Punch Like a Girl' scheme in Blaenau Gwent empowering young women in martial arts to take on leadership roles and excel in their sport working with the fighting chance foundation <https://fightingchancefoundation.org.uk>. The

female coaches and leaders that take part in the 'Punch Like A Girl' scheme will then go on to lead our women only sessions.

- Create 'women only sessions' for women to learn self-defence, improve their fitness and their self-confidence working in partnership with trauma counselling services such as New Pathways New Pathways Rape crisis and sexual abuse support services, and Women's Aid charities.
- Create men's mental wellbeing sessions working in partnership with Men's mental health charities such as helpu Get Involved - helpu.org.uk - The Mental Health Hub for Men in Wales.
- Create 'Quiet Sessions' once a month for young people with additional needs to access the gym when there are fewer people using the gym working in partnership with the National Autistic Society, One Life Autism Support Group and others.

We will achieve these objectives by using the Solar Farm Grant in the following ways;

- Fund the travel and subsistence expenses for our hard-working team of volunteers who already support our community events.
- Procure new equipment to allow us to create a 'traveling kit' to take with us to community events.
- Create secure storage at our new premises to store expensive kit items.
- Cover trainer expenses at community events.

How will your project improve the local environment?

We will use the Solar Farm Grant to create environmental enhancements at our new premises that will help to reduce our impact on the environment through greater energy efficiency, to ensure that we compliant legislation from the Welsh Government around recycling for businesses and charities, to provide an asset to our community, and a positive impression for the young people using our facilities. These improvements provide an opportunity to engage the young people we work with, with messages of environmental stewardship which they will hopefully take with them into the wider community. Our new premises also come with a small amount of green space which we plan to revitalise. Once the improvements to our building and green space are complete, we will invite the local community to a BBQ to celebrate the launch of our new community provisions.

How does your project contribute to sustainability?

Celtic Pride already contributes to the economic sustainability of Blaenau Gwent by bringing in members of the local community and surrounding communities to Abertillery and helping to support local businesses. Annual events such as Inter-clubs and twice annual fight shows also bring in other gyms and individuals from the wider South Wales Area. Our twice annual fight shows are held at Ebbw Vale Leisure Centre directly supporting the local community



through paying for the venue, bringing in hundreds of paying customers and supporting local businesses who provide catering services at these shows. The Solar Farm Grant will help to increase the sustainability of Celtic Pride by enabling us to bring Martial Arts to a wider range of the community who may in turn choose to attend and support the gym. The Solar Farm Grant will also help us to be firmly embedded as a resource to communities in Blaenau Gwent for mental wellbeing, fitness, and a sense of community belonging to a sports club.

The Solar Farm Grant will also enable us to enhance our sustainability from an environmental perspective through our environmental enhancements and provision of recycling facilities at our new premises.

How does your project promote volunteering?

The committee for the Community Amateur Sports Club is made up of volunteers who contribute their time to meetings, activities outside of business operations and sourcing funding for the CASC free of charge.

All of the Community Engagement project activities mentioned above will be led by trainers who will contribute their time in kind and volunteers. Events will also be staffed by volunteers. To retain our volunteers and encourage future volunteers we want to support our volunteers by providing reimbursement for travel costs and subsistence while volunteering, the gym will also contribute free training sessions to volunteers as a thank you for their time.

How does your project promote links between communities?

Our lead coaches Stephen Giffard and Greg Creel are imbedded in the local community of Abertillery and the wider area. They are well known in their communities for their work creating and sustaining a successful business as well as for their work at community events bringing business to the area and creating a community around martial arts in Blaenau Gwent.

Our secretary previously worked for 5 years as a Community Engagement Officer in Blaenau Gwent. She has strong links with many primary and secondary schools in Blaenau Gwent, the Summer Holiday Enrichment Programme in Blaenau Gwent as well as many charities working with children with autism and other additional needs. She will utilise her contacts to create links with schools, charities, and youth groups in Blaenau Gwent to promote our school sessions and quiet sessions for children with additional needs.



In addition to the work Celtic Pride already does creating a flourishing community for martial arts in Blaenau Gwent, we also plan to expand our presence at community events such as Aberfest, Six Bells Pit Party, events at Llanhilleth miners Institute and the Abertillery based Party in the Park. The Solar Farm Grant will allow us to expand our activities through the creation of 'Travelling Kit' for use at these events.

How does your project help deliver the seven well-being goals in the Wellbeing of Future Generations (Wales) Act 2015, namely:

A Prosperous Wales

As mentioned above, Celtic Pride contributes to the economic sustainability of the Blaenau Gwent area and as successful business owners, Stephen and Greg provide economic benefit to Abertillery.

Celtic Pride has also trained and supported many of our members to go on to pursue successful sporting careers. Mason Jones, a longtime member of Celtic Pride now earns a living as a professional athlete. Celtic Pride also supports our members in further education in sports coaching and to create their own small businesses. Some of our members have started their own personal training businesses and Celtic Pride have even provided gym space free of charge to members to help to support their new endeavours. We aim to continue to support the progression of our members and any future members who come to Celtic Pride through this project.

A Resilient Wales

Celtic Pride already contributes to the economic resilience of Abertillery and the surrounding area and through this project we aim to enhance these contributions as outlined above. This project will also help us to create environmental sustainability of our new premises and future activities. We also want to create a resilient future for Celtic Pride where we can continue meaningfully contributing to our community for a long time to come.

A Healthier Wales

At Celtic Pride we promote an environment of active living and healthy lifestyles for all our members but especially the children and young people who use our gym. Blaenau Gwent has the highest levels of antidepressant prescription of any local authority in Wales. Physical fitness can be an important tool for mental wellbeing and as such we want to create monthly Men's Mental Wellbeing sessions as part of our community engagement offering. We have included an excerpt from a testimonial from one of our members about his



personal health journey and hope to help many more individuals to improve their physical and mental wellbeing.

"6 months ago I was riddled with anxiety and depression i had no self confidence as a person and weighed 20st and felt useless. But living where i do you see this happening all to often to those around you and you convince yourself its the norm. The doctors answers were to put me on antidepressants and anxiety medication for the rest of my life which i endured for a year or so, but one day last year i looked around and noticed almost everyone i know was taking antidepressants and none of them ever got better from it and it was time to make a change... Well iv been training at Celtic Pride Martial Arts for just over 6 months now and i never felt better in my life, i have been free from my antidepressants for over a year now and have never felt mentally and physically this strong ever. I have lost 4st in 6 months that i really couldn't give a shit about, i didn't start training to loose weight i started to save myself from depression. its just something that comes with training your ass off who knew!

All that is left to say is a massive thank you to Stephen Giffard , Greg Creel, Jamie Hughes and Mason Jones and all my team mates at Celtic Pride Martial Arts for helping me. And i look forward to the future training with you guys. thanks :)"

A More Equal Wales

A key part of this project is to increase accessibility of martial arts to a more diverse community of people including women, children with additional needs, and individuals with mental health struggles.

A Wales of cohesive communities

At Celtic Pride we already work to bring different areas of our community together through sport. Individuals from all over Blaenau Gwent and the surrounding areas come to train at our gym and members of gyms from the wider South Wales area come to attend our events. We also pride ourselves on our work with young people providing a supportive and constructive culture. We have provided training to local young people free or at reduced charge for struggling families in an effort to keep young people active and off of the streets. Some members of our adult groups are also rehabilitated ex-offenders who have changed their lives through sport and are now contributing members of the community.

A Wales of vibrant culture & A globally responsible Wales

Some members of Celtic Pride have gone on to compete internationally. Two of our youth athletes competed and won gold at international competition and were part of the first team to represent Wales at that event. We are proud to be part of Wales sporting accomplishments and hope to represent our country at future events. Our young people also benefit hugely from experiencing different countries and cultures and broadening their horizons.



If funding is granted, what will successful delivery of the project look like?

We have summarised project delivery in the attached Gantt Chart.

Quarter 1

In quarter 1 we will primarily focus on the environmental enhancements to our new premises including energy efficiency enhancements and procurement of recycling facilities and signage.

During quarter 1 we will also make a start on our new community provisions by designing a secure storage facility in our new premises for new kit items. We will also begin the application process for 'Punch Like A Girl' for some of our upcoming young female athletes. We hope that the young women who are part of this scheme will also help to develop and manage our women only sessions with support from staff.

We will write and submit a report at the end of this quarter.

Quarter 2

In quarter 2 we aim to open our new premises and install our new recycling facilities and signage. We will also begin work on enhancing the green space outside of our new premises.

During quarter 2 we will also procure and develop a 'Travelling Kit' for community sessions, begin advertising school sessions and training for emergency service workers.

We will review progress on these milestones and write and submit a report at the end of this quarter.

Quarter 3

In quarter 3 we aim to have completed the environmental enhancements for our new premises including the green space.

Quarter 3 is when we aim to roll out many of our community engagement events including a BBQ for local residents, school sessions, training for emergency service workers, and women only sessions. We will also provide sessions at Summer Holiday Enrichment Provisions during this time and attend community events.

We will review progress on these milestones and write and submit a report at the end of this quarter.

Quarter 4

In quarter 4 we will re-advertise school sessions for the new academic year, men's mental wellbeing sessions, and quiet sessions. We will continue to run training for emergency



service workers, and women only sessions and aim to start men's mental wellbeing sessions, and quiet sessions. We will also provide sessions at Summer Holiday Enrichment Provisions during this time and attend community events.

We will review progress on these milestones and write and submit a report at the end of this quarter.

Will you (and when will you) supply completion reports / evidence / photos?

Completion reports and evidence including photos will be submitted to the council every quarter by the club secretary, referring back to the specific project goals and timeframes outlined in the attached Gantt chart. We also have an active social media presence where we will post photos and content relating to activities funded by the Solar Farm Grant.

Is your organisation a: Charity/community group/sports club/company/not for profit business/other (explain and provide evidence)

Celtic Pride Martial Arts is currently incorporated as a Limited company. We have begun the process to separately incorporate as a Community Amateur Sports Club which will allow us to broaden our community work.

Payee Details

Name:

Signature:

Print Name:

Date:

* Profit business? *

ALCC ClerkMailbox

From: stephen giffard [REDACTED]
Sent: 05 June 2024 19:22
To: ALCC ClerkMailbox
Subject: Re: Solar Farm Grant Application

Hi

Sorry just catching up on emails as I have been away.

We are a company at the moment however we are in the process becoming Casc.

Our banking details are

[REDACTED]

Yes our club secretary is Sarah Morgan
Treasurer is Greg Creel
Chairman is Stephen Giffard
Owners Greg Creel and Stephen Giffard.
(Do you need contact details?)

The money would be spent on gym equipment. Boxing ring, Pads and cardio equipment.
(Do you need a total breakdown on items?)

The money already spent is from an investor (I can give you his details if required?) they have purchased a new building for our new venue.

Let me know if you need anything else.

Many thanks
Stephen

Sent from my iPhone

On 4 Jun 2024, at 12:16, ALCC ClerkMailbox <clerk@abertilleryandllanhilleth-wcc.gov.uk> wrote:

Good afternoon Stephen

Thank you for completing and returning your Solar Farm grant application. We need clarification on a few points and some further information before we can pass the application to Council.

1. What type of organisation are you? For example, a community group, not for profit etc.
2. Please supply your bank details. Account name, sort code and account number
3. Do you have a management committee/structure? For example, a secretary, treasurer and chair? If so, what are their names?
4. What will the money be spent on – specific details required
5. Where has the money come from that has already been raised?

We would be grateful if you could inform us of this Information as soon as possible

Kind regards

Erika Davies

Deputy Clerk

Phone | Ffon: 01495 217323

Website | Gwefan: <http://www.abertilleryandllanhilleth-wcc.gov.uk>

Council Offices, Mitre Street, Abertillery, Blaenau Gwent, NP13 1AE

Swyddfeydd y Cyngor, Heol Mitre, Abertyleri, Blaenau Gwent, NP13 1AE

This email has been scanned for spam & viruses. If you believe this email should have been stopped by our filters, [click here](#) to report it.

Abertillery and Llanhilleth Community Council (ALCC)

Solar Farm Grant 2024 – Application

(see criteria and process attached before applying)

Name and Address of your group or organisation:

Blaenau Gwent Methodist Church and Abertillery Town Band

Contact name: ...Sian Millar

.....

Role in group: ...Secretary

.....

Telephone number

[REDACTED]

.....

Email:

[REDACTED]

.....

What is the name of your project? ...Abertillery Music Academy and Community Hub

.....

.....

What are the aims of the project? Aims of the Music Academy... To provide free tuition and instruments for young people in Abertillery and surrounding district.

To provide brass and percussion tuition in a safe, social environment.

To provide performance opportunities for the Academy Band to entertain the local community.

To link with the local schools to provide a joint school and Band musical education.

Aims of the Community Outreach Component

To provide a hub for the community to attend and listen to concerts by the Academy Band.

To provide not only entertainment, but also refreshments and support.

To offer company and friendship for those who are lonely and who may find it difficult

to meet and relate to other people.

To offer the opportunity of inter-generational liaison which will benefit young and older alike.

To create the opportunity for the Band and the Church to be part of the Well-Being Network, helping to improve the health and well-being of those who attend the Academy Hub.

To play a part in achieving a stronger community, through partnership working.

.....

.....

.....

.....

How will your project benefit the Abertillery and Llanhilleth area or its residents? ... The Music Academy and Community Hub will provide a safe place for the young people of the area. The Academy will develop their musical skills and will also help to increase their confidence levels and improve social interaction. The Young People will experience the power of performance which so increases self-esteem and confidence. The Young People will find a purpose and goal to achieve whilst also establishing friendships. Some young people may also find career opportunities through music and performance.

The Community Hub will help link the young and old, with the older people enjoying the company of the young people and the young people learning to care for and relate to the older citizens who attend the Hub. The Hub will provide friendship and company - but it will be more than a cup of coffee and a chat. They will be entertained by the Academy Band, which gives an added focus for those who are more reserved and shyer in social settings. We hope this approach will be more inclusive and put people at ease – linking people through the healing power of music.

.....

Approximate number of beneficiaries 150, including the children involved through the school......

What will be delivered as a result of the Solar Farm Grant? ... The Band rehearses in Blaenau Gwent Methodist Church and this building now houses the developing Academy Band. Plans are in place to refurbish and reconfigure the building but there is an immediate need to improve the heating system now that the band are making considerable use of the building. The current heating system is inefficient, costly and not energy efficient or environmentally friendly. A quote to replace the system is estimated at £15,000. Any funds received from the Solar Farm Grant will help to provide a more viable heating system and ensure the space is efficiently heated for the young people in the Academy and the Band. It should be noted that a replacement heating system now will fit with the whole refurbishment

plans which will be delivered in the future.....

Project costs:

A. Project costs met by your group	Amount (inc. VAT)
Free tuition and instruments provided for beginners. But need follow-on instruments and resources.	£
	£
	£
Sub Total	£
B. Funding being provided by other organisations	Amount (inc.VAT)
Beginners' Instruments funded through Community Voice Community Choice	£ 7,633
ALCC Funding for workshops	£ 2,040
Sub Total	£9673
C. Funding requested from ALCC Solar Farm Grant	Amount (inc.VAT)
To replace the heating system	15,000
Sub Total	15,000
D. Total project costs (A + B + C)	TOTAL
	24,673

How will your project improve the local environment? ... The plans to refurbish the church building to provide appropriate facilities for the Music Academy will help to maintain and improve the environment around the church. The building will be refurbished taking account of environmental benefits and energy efficiency. A new heating system will ensure the building is more energy efficient.

.....

.....
.....
.....
How does your project contribute to sustainability? Young People are the future of the brass band movement, and the Music Academy will encourage and inspire young people to make music and be involved in brass banding. This is essential for the sustainability of the brass band movement and provides numerous benefits to young people.

The Project, with the Academy Hub and Community Outreach will help sustain the church and the local community, providing support and help to those in need – building a stronger community.
.....
.....

How does your project link with local schools? ... The link with local schools is an important element of the Academy and the band has provided instruments for school use.....
.....
.....

How does your project promote volunteering? ... There are opportunities for volunteers to work in the Hub with the preparation and distribution of refreshments, talking to Hub attenders, helping with IT facilities, distribution of food and clothing if needed.....
.....
.....

How does your project promote links between communities? There are no demarcation lines – the school children will be from across Abertillery and Llanhilleth and it will be an open invitation to attend the Academy and the Hub. We will continue to support our communities by playing at community events right across the area.
.....
.....
.....

How does your project help deliver the seven well-being goals in the Well-being of Future Generations (Wales) Act 2015, namely:

- A prosperous Wales

- 101 116 131 146 161 176 191 206 221 236 251 266 281 296 311 326 341 356 371 386 401 416 431 446 461 476 491 506 521 536 551 566 581 596 611 626 641 656 671 686 701 716 731 746 761 776 791 806 821 836 851 866 881 896 911 926 941 956 971 986 1000

We will teach our young people to care for each other and those in our communities and to treat others with dignity and respect. We believe these are essential building blocks to create resilient communities.

We will be equal and inclusive, welcoming all, regardless of background, gender, race or ability and our project has music at its heart with an emphasis on performance – this will contribute to a **Wales of vibrant culture**.

We will also seek to ensure that there are career opportunities available for our young people attending the Academy and encourage advancement and employment where we can.

[illegible]

.....
.....
.....
.....
.....
.....
.....

(continue on a separate sheet if needed)

If funding is granted, what will successful delivery of the project look like?

.....An established Music Academy for Young People with appropriate
resources, instruments and free tuition. Also providing
workshops throughout the year.

A better sustained and equipped Senior Band to which the learners can progress.

A better sustained Church at Blaenau Gwent Methodist.

An established Community Hub linking the Academy, Band and Church to the local
community.

The inclusion of music at the heart of the community.

.....
.....
.....
.....

Will you (and when will you) supply completion reports / evidence / photos?

..... Yes

...

.....

Is your organisation a: Charity/community group/sports club/company/not for
profit business/other (explain and provide evidence)

.....
...Charity – Charity Commission Number 1039267
.....
.....
.....

Payee name:

.....

Signed:

.... S Millar

.....

Print Name:

...SIAN MILLAR

.....
Date:22.5.24
.....

This form must be submitted with any relevant supporting documents you wish to submit (e.g. business plan, group constitution, bank or financial statements, letters of support etc) to Abertillery and Llanhilleth Community Council by Friday 31st May 2024, either by post to Town Clerk, Abertillery and Llanhilleth Community Council, Mitre Street, Abertillery, NP13 1AE or email clerk@abertilleryandllanhilleth-wcc.gov.uk.

CONSTITUTION AND RULES OF ABERTILLERY TOWN BAND

- 1. The band shall be called the ABERTILLERY TOWN BAND.**
- 2. a) The aims of the Band are to further the musical education of young brass and percussion players by means of concerts, competitions and other activities.**
b) All monies raised will be re-directed into the furtherance of the Band's aims.
- 3. The Membership of the Band shall consist of playing Members, either Youth, Training or Beginners, parents or guardians of playing Members and any other interested individual. A Management Committee will be elected to administer the running of the band. Admission to the Band of playing Members is by audition with the Musical Director, seconded by the Committee.**
- 4. Subscription rate is to be decided on a yearly basis by the Committee and is payable weekly to the Subscription Secretary. Any band member may approach any Committee member, confidentially about a reduced subscription, who must then make representation on the member's behalf to the Committee.**
- 5. Band members will be expected to comply with the Code of Conduct. See Appendix 1. The Committee shall terminate the Membership of any Member whose conduct at rehearsal or upon any premises occupied by the Band or elsewhere is considered unseemly, objectionable or calculated to bring the Band into disrepute. The Secretary shall immediately give to such a Member notice of such a decision of the Committee specifying the reason for their decision. Appeal can be made to the Band in writing within 14 days. If such a notice shall be given by the Member within the specified period then the Secretary shall forthwith convene a General Meeting of the Band giving to all members not less than seven or more than 24 days notice thereof.**
Such a General Meeting shall consider only a resolution that the Membership of the Member in question be terminated and no other business shall be taken at the Meeting. In any event the Member in question shall have no remedy whatsoever against the Committee, the Band or any Member thereof resulting from or relating to any allegation which may have been made during or in connection with any of the proceedings authorised by this rule.
- 6. a) Any person shall, upon ceasing to be a Member of the Band, forfeit all rights to and claim upon the Band and its property and funds.**
b) Any playing Member of the Band upon accepting registration to any other Band shall forfeit all rights and claims upon the Band and its property and funds.
- 7. Each Member on receiving his or her instrument, uniform, music or other Band property may be required to furnish the Committee with a receipt for same or sign a book for same and kept for such a purpose. He or she shall be held responsible for the maintenance of Band property to the satisfaction of the Committee that their damage or loss was the result of an unpreventable accident.**
All property received shall be used for Band purposes and no player shall loan or transfer his or her instrument or other property to any other Member without the written consent of the Committee.

On leaving or being expelled from the Band he or she shall hand over all Band property in his or her possession in good order to the Committee.

8. The Band will meet for practice on a regular basis determined by the Committee. Any Member absenting himself/herself for three consecutive practices without good reason will be liable for disciplinary action. Advance notice of absence from practice should be given.

9. Should a dispute at any time arise in the Band room or during an engagement the Musical Director shall give a temporary decision which must be acted upon but should any Member feel aggrieved he or she may appeal to the Committee who shall decide the matter and their decision shall be final.

10. The Committee shall be elected annually at the Annual General Meeting and shall consist of Chair, Secretary, Treasurer, three Band representatives and ordinary Members.

11. The Committee shall have the power to appoint a Member as an additional Member of the Committee or to fill any casual vacancy on the Committee or among the Officers until the next Annual General Meeting or to carry out an activity in support of the Band.

12. A Musical Director shall be appointed by the Committee on such terms and conditions as may mutually be agreed upon whose duties shall be to attend to all musical instruction and rehearsals and prepare the Band for all engagements and contests and serve on the Committee if required.

13. All Meetings of the Committee and of any sub-committee thereof and of any Members of the Band shall be chaired by the Chairman or in his/her absence by the Vice-Chairman or in the absence of both of them then by the Treasurer. The Chairman of any Meeting shall be entitled to vote on any resolution and in the event of a tie shall have a second or casting vote. No Committee Meeting or Sub-committee Meeting shall take place with less than 8 members.

14. There shall be three Trustees of the Band who shall be appointed at the AGM.

15. The Chairman may from time to time, and shall at least six times in every year, convene a Committee Meeting by giving seven days notice thereof to the Members of the Committee. Eight Members of the Committee shall form a quorum. Minutes shall be taken of all proceedings of the Committee and shall be open to the inspection of any Member of the Band after the said minutes have been approved and accepted by the Committee.

16. All money payable to the Band shall so far as is practicable to be paid to the Treasurer but if this is not practicable may be paid to any other Officer of the Band or any Member of the Committee who shall forthwith hand the same to the Treasurer. The Treasurer shall keep a record of all income and expenditure of the Band; pay all accounts for payment and prepare an annual statement of accounts duly audited and submit the same at the Annual General Meeting.

He/she shall also, in his/her own name and that of the Chairman and the Secretary, deposit all monies belonging to the Band in the bank of the Band, namely: - Lloyds

TSB and no withdrawal will be authorised without the signatures of two of the three parties named.

17. The Committee may at any time for any special reason call a Special General Meeting, and shall do so forthwith upon there being delivered to the Secretary the requisition in writing of any six members stating the purpose for which the Meeting is required.

A Special General Meeting held pursuant to such a requisition shall take place within 14 days of its being received by the Secretary, and the Secretary shall give to all the Members at least seven days notice of any Special General Meeting and the business to be transacted thereat.

In default the requisitionists may themselves convene a Special General Meeting by giving such notice as aforesaid to the Members and for this purpose shall be entitled to require the Secretary to notify them in writing of the names and addresses of all the current Members of the Band.

18. Any Officer of the Band or Member of the Committee may be removed by resolution of a General Meeting of the Band. Any resolution of a General Meeting of the Band the effect of which would be to remove from office any Officer of the Band, a Trustee of the Band or a Member of the Committee or to deprive a Member of the Band of the benefits and privileges of Membership shall require a majority of two thirds of those Members present and voting and the vote on any such resolution shall if so required by any Member present be taken by secret ballot.

19. The Annual General Meeting of the Band shall be held following the first day of February, in each year, upon a date and at a time and place to be fixed by the Committee for the following purposes: -

- a) To receive from the Committee report, balance sheet and statement of accounts for the preceding year.
- b) The election of Officers and the Committee.
- c) To review Honoraria, subscriptions and fees
- d) To appoint an Auditor or Auditors for the ensuing year.
- e) To decide on any resolution seven clear days notice of which shall be given to the Secretary, and
- f) To transact any other business considered by the Chairman to be proper to be taken at the Annual General Meeting of the Band.

The Secretary shall give to all members at least 14 days notice of the date fixed for the Annual General Meeting.

20. The Auditor or Auditors shall prior to each Annual General Meeting and on such other occasions as they shall think fit, examine the books of accounts of the Band with the invoices and vouchers in the possession of the Band and shall append to such accounts a certificate to the effect that they are correct and represent a true picture of expenditure receipts, assets and liabilities of the Band (or as the case may be) and they may at any time inspect any book, document or property of the band in the possession of any Officer or Member and make a report thereon in writing to the Committee and (if he/they think fit) circulate copies of such report to all Members of the Band.

21. The Committee shall have power to pay accounts and incur any normal liabilities on behalf of the Band and the Committee and Officers are hereby indemnified by the

Members of the Band against all claims and demands in respect of any liability and bona fide incurred by them in the name of or on behalf of the Band.

22. The decision of the Committee upon any question of the interpretation of these rules or upon any matter affecting the Band and not provided for by these rules shall be final and binding to all Members.

23. a) The Band may only be dissolved by a resolution passed by a unanimous vote of all those Members present and voting at a General Meeting of the Band. Any such resolution shall give instructions for the disposal of any assets held by the band after all debts and liabilities have been paid, in accordance with the following sub-clause hereof.

b) In the event of the Band being dissolved or wound up (whether under the preceding sub-clause hereof or otherwise) the balance of any assets held by the Band after all debts and liabilities have been paid shall not belong to the Members of the Band but shall be given or transferred to some Charitable Institution or Institutions having aims similar to those of the Band and specified in a resolution of the General Meeting of the Members of the Band or (as the case may be) of the persons who were its Members immediately before its winding up. Such resolution may be incorporated in a resolution to wind up the Band under the preceding sub-clause hereof but otherwise shall require not more than a simple majority of votes of those present and voting at such a meeting.

24. These rules may be added to, repealed or amended by resolution at any General Meeting of the Band providing that no such resolution shall be deemed to have been passed unless it is carried by a majority of at least two-thirds of the Members present and voting thereon.

Also provided that no addition, repeal or amendment shall be made to these rules which would cause the Band to cease to be a Charity at law or which would permit any asset of the Band on winding up to be transferred otherwise than to a Charitable organisation or organisations having aims similar to those of the Band.

25. The Band will apply an equal opportunity policy. See Appendix 2. It is intended that no person shall receive less favourable treatment on the grounds of sex, physical disability, colour, race, nationality or ethnic/racial/national origins or is disadvantaged by any conditions or requirements that cannot be shown to be properly justified. Any dispute arising from this will be dealt with through an extraordinary Committee Meeting. The Committee decision shall be final.

26. The band will have a Child Protection Policy and follow Child Protection Procedures. See Appendix 3



STRUCTURAL ENGINEERING : PROJECT MANAGEMENT

Our Ref JS/SAW/2024- Fee Bid

14th February 2024

FAO Sian Miller
Blaenau Gwent Methodist Church Secretary
Blaenau Gwent Methodist Church
Ty Bryn Road
Abertillery
NP13 1PH

Dear Sian

Re: Blaenau Gwent Methodist Church Hall Extension - Tender for Multi-Disciplinary Services

Thank you for your valued enquiry, having had the opportunity to review the information you sent to me I have pleasure in providing our fee quotation.

To provide a multi-disciplinary team to cover all the disciplines outlined in your tender enquiry letter we would propose the following. At this stage without detail of the budget for the project we are unable quote a fixed fee but would be happy to quote a percentage fee which we would convert to a fixed fee once the project costings are established.

- To carry out the Development Phase work (RIBA 2-RIBA 4) 65% of an overall 10% fee
- To carry out the Delivery Phase work (RIBA 5-RIBA 7) 35% of an overall 10% fee.

All fees would be subject to VAT at the standard rate.

In relation to our appointment, Blaenau Methodist Church would be entering into contract with Salt Consultancy Ltd whose Company Registration Number is 7503729 and the company maintains Professional Indemnity Insurance in the sum of £2.0m any one claim. Any sub consultants used by Salt Consultancy are required to maintain back to back levels of insurance and terms and conditions.

We would suggest a standard ACE agreement for the appointment of Consultants is adopted between our organisations unless you have your own form of documentation. Once again we would employ similar documentation between ourselves and any sub consultants. We would be more than happy to help prepare the documentation for signature if so required.

We would be grateful for your consideration in relation to payment terms of 30 days and secondly payments by monthly draw down. A monthly draw down would also enable a cash flow forecast from day one.

Should the above be acceptable we would look to working with you

Yours Sincerely,

J Salt IMIStructE IEng FFB

Director

Salt Consultancy Ltd

ABERDEEN TOWN BAND CHARITY N
1039267
INCOME/EXPENDITURE FOR 1.01.23-31.12.

INCOME.

Contributions/subs

Grants

Donations

Miscellaneous/cash

Vehicle/bank/insurance refund

Easy fundraising

TOTAL.

EXPENDITURE

ALCC ClerkMailbox

From: Sian Millar <sianmillar@outlook.com>
Sent: 24 May 2024 20:28
To: Sian Millar

BLAENAU GWENT METHODIST CHURCH

STATEMENT OF ACCOUNTS SEPTEMBER 2022 – AUGUST 2023

INCOME		EXPENDITURE	
B/Fwd.	2651.92		
POWELL STREET TRANSFER	4500.00	ASSESSMENT	8100.00
COLLECTION	7044.98	DONATIONS	172.08
DONATIONS	663.00	INSURANCE	496.85
BEQUESTS	1000.00	MAINTENANCE	9551.58
FUND RAISING	165.12	ELECTRICITY	1112.05
GRANTS	11446.45	BANK CHARGES	80.00
HIRE FEES	700.00	MISCELLANEOUS	120.00
INSURANCE SETTLEMENT	1263.68		
TOTAL	29435.15		19632.76
Carried Fwd.	9802.39		
DEPOSIT A/C	802.91		

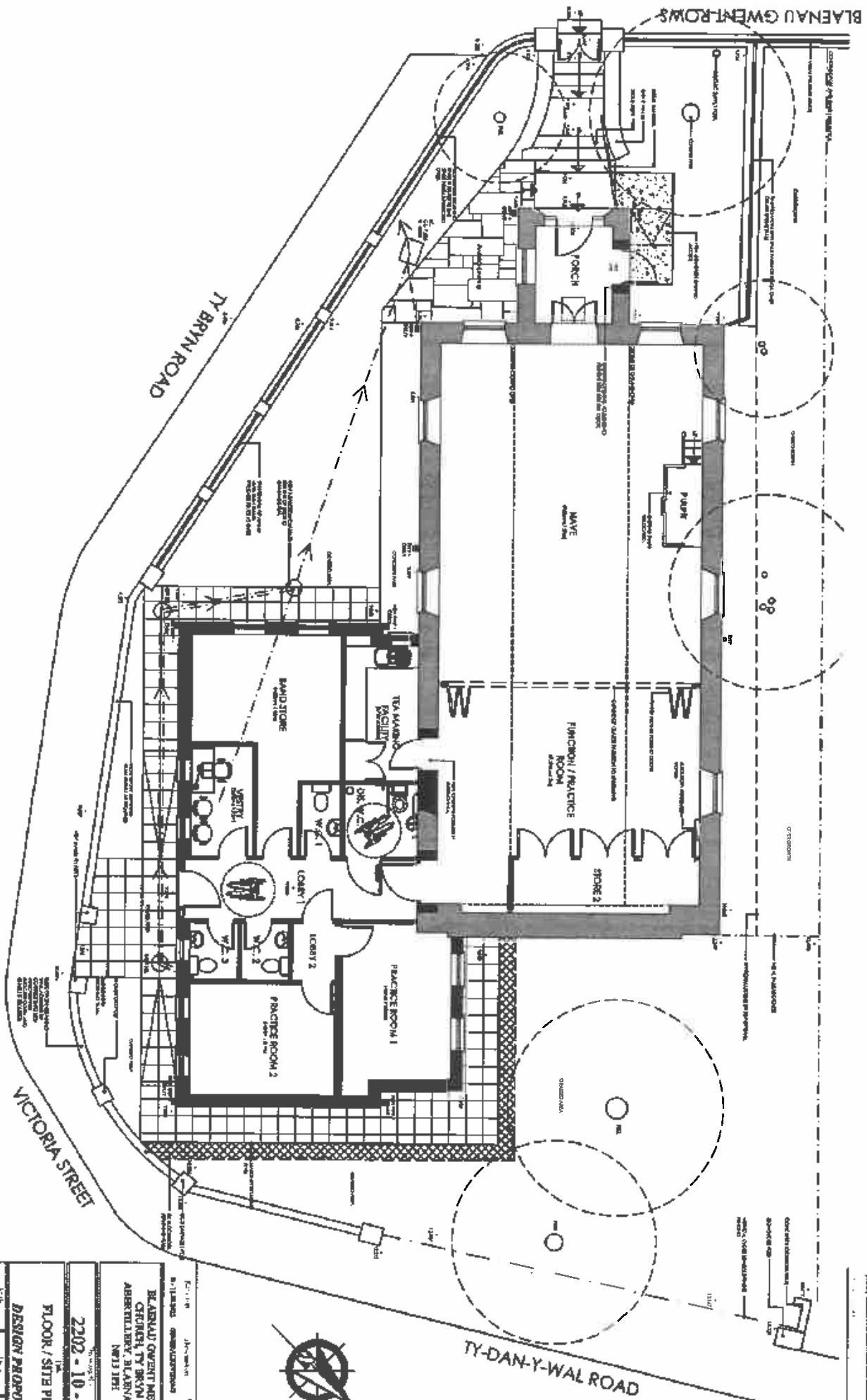

This drawing is not to be used for any other purpose than that for which it was prepared. It is the responsibility of the client to ensure that the drawing is used for the purpose for which it was prepared. The client is responsible for ensuring that the drawing is used for the purpose for which it was prepared. The client is responsible for ensuring that the drawing is used for the purpose for which it was prepared.

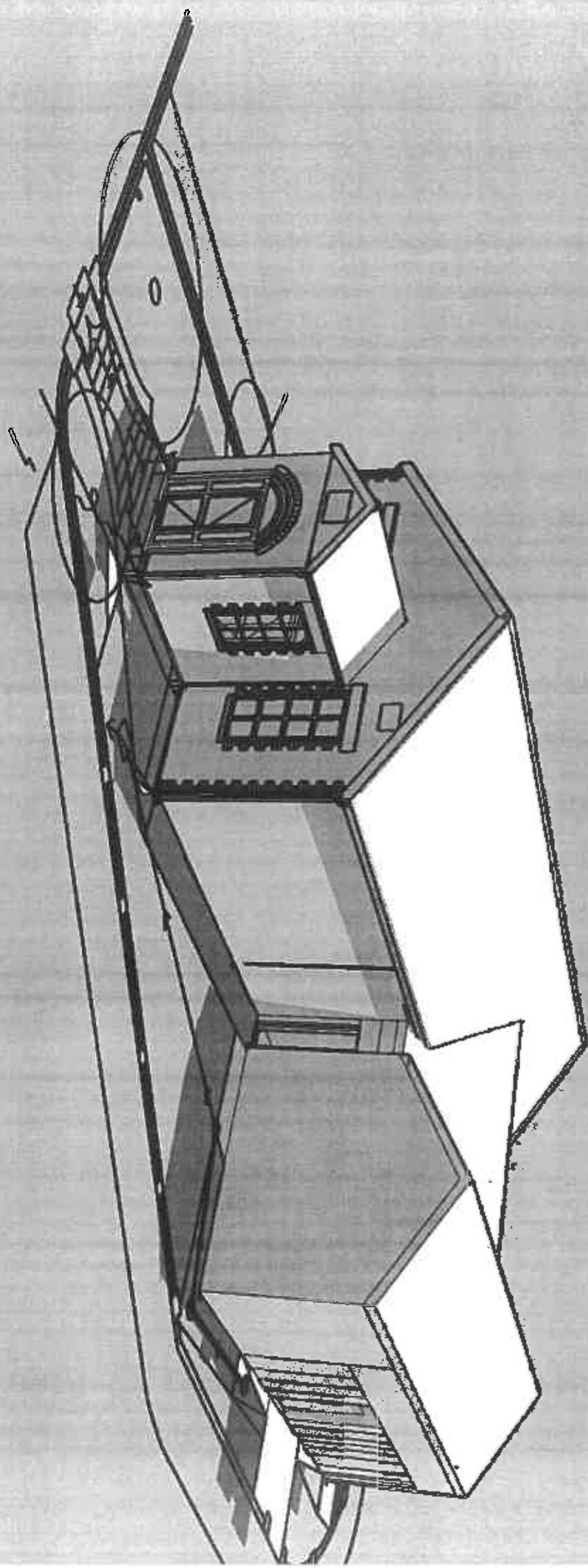

ALCC ClerkMailbox

From: Morgan, Sarah (PSHA)
Sent: 23 May 2024 11:52
To: Sian Millar
Subject: Testimony for Funding Application

Hi Sian,

please find my letter for the funding application below 

Very best wishes,

Sarah

My 15 year old son Robbie has been attending brass lessons with the Abertillery Brass Band for the last 5 months. In that time, the progress he has made is unbelievable. Robbie chose to learn Saxophone for his GCSEs. He started out as a somewhat reluctant saxophone beginner to an enthusiastic and promising trumpet, euphonium, and saxophone player! He has also begun to make excellent strides with his music literacy and often uses terminology and mentions notation that I have never heard of! The support Robbie has received from the team at Abertillery Brass Band has been phenomenal. They are all so kind and supportive. One of the most unexpected benefits from being part of the band are the intergenerational links that are forged within the community. Robbie has learned so much from the more experienced members of the band who he would otherwise likely never have interacted with. Every week when I pick him up, Robbie is always excited to share the new things he has learned and the praise he has received from his tutors. Robbie has Autism and Attention Deficit Disorder which can mean that he finds it difficult to focus and can sometimes be full of chaotic energy! But the team have been so understanding and patient which I think has been key to how quickly Robbie has taken to brass. Robbie's current goal is to perform a solo at the upcoming Christmas concert. With the support of the brass band team, I'm sure he can get there!

A huge thank you to everyone at the Abertillery Brass Band, you are all amazing.

Pronouns: She/Her

Community Engagement Officer,
Flat Holm: A Walk Through Time
Cardiff Harbour Authority

[Check out our blog!](#)
[Like us on Facebook @flatholm](#) [Follow us on Twitter @flatholmers](#) See us on Instagram [flatholmisland](#)
Funded by the National Lottery Heritage Fund



The Council welcomes correspondence in Welsh, English or bilingually. We will ensure that we communicate with you in the language of your choice, as long as you let us know which you prefer. Corresponding in Welsh will not lead to delay.

Privileged/Confidential Information may be contained in this message. If you are not the addressee indicated in this message (or responsible for delivery of the message to such person), you may not copy or deliver this message to anyone. In such case, you should destroy this message and kindly notify the sender by reply email. Please advise immediately if you or your employer does not consent to Internet email for messages of this kind. Opinions, conclusions and other information in this message that do not relate to the official business of the Council of the City and County of Cardiff shall be understood as neither given nor endorsed by it. All e-mail sent to or from this address will be processed by Cardiff County Councils Corporate E-mail system and may be subject to scrutiny by someone other than the addressee.

Mae'r Cyngor yn croesawu gohebiaeth yn Gymraeg, Saesneg neu'n ddwyieithog. Byddwn yn cyfathrebu â chi yn ôl eich dewis, dim ond i chi roi gwybod i ni pa un sydd well gennych. Ni fydd gohebu yn Gymraeg yn arwain at oedi.

Mae'n bosibl bod gwybodaeth gyfrinachol yn y neges hon. Os na chyfeirir y neges atoch chi'n benodol (neu os nad ydych chi'n gyfrifol am drosglwyddo'r neges i'r person a enwir), yna ni chewch gopio na throsglwyddo'r neges. Mewn achos o'r fath, dylech ddinistrio'r neges a hysbysu'r anfonwr drwy e-bost ar unwaith. Rhowch wybod i'r anfonnydd ar unwaith os nad ydych chi neu eich cyflogydd yn caniatáu e-bost y Rhyngrwyd am negeseuon fel hon. Rhaid deall nad yw'r safbwyntiau, y casgliadau a'r wybodaeth arall yn y neges hon nad ydynt yn cyfeirio at fusnes swyddogol Cyngor Dinas a Sir Caerdydd yn cynrychioli barn y Cyngor Sir nad yn cael sel ei fendith. Caiff unrhyw negeseuon a anfonir at, neu o'r cyfeiriad e-bost hwn eu prosesu gan system E-bost Gofforaethol Cyngor Sir Caerdydd a gallant gael eu harchwilio gan rywun heb law'r person a enwir.

ALCC ClerkMailbox

From: Sian Millar [REDACTED]
Sent: 05 June 2024 12:22
To: ALCC ClerkMailbox
Subject: Re: Solar Farm Grant Applications

Hello Erika,
Thanks for your e-mail. Regarding the points raised:

1. For all three applications, any funding awarded would be spent for the purpose requested. If we need to top-up the funding, we will endeavour to fund raise and apply for further grants. Any funding already secured will be used for the purpose stipulated.
2. The bank details:

Abertillery Town Band,

Lloyds Bank

Sort Code - [REDACTED]

Account Number - [REDACTED]

3. Chairman - Mr Nigel Bard; Secretary - Mrs Sian Millar; Treasurer - Mr C Ryan
4. The funds already secured and noted in Section B, contribute to the total project. But if only one application can include it, please allocate to the Bid for tuners, mutes and instrument refurbishment.

I hope this is clear for you Erika - just contact me if you need further information.
Kindest regards,
Sian.

From: ALCC ClerkMailbox <clerk@abertilleryandlanhilleth-wcc.gov.uk>
Sent: 04 June 2024 12:08
To: 'Sian Millar' [REDACTED]
Subject: Solar Farm Grant Applications

Good afternoon Sian

Thank you for completing and returning your Solar Farm grant application. We need clarification on a few points and some further information before we can pass the application to Council.

1. If successful, what would the awarded money get spent on if the other proposed funding falls through?
2. Please supply your bank details. Account name, sort code and account number
3. Do you have a management committee/structure? For example, a secretary, treasurer and chair? If so, what are their names?
4. On all 3 applications you have included funding under section B. Please confirm which application you want it on. The same cost cannot be included for the project in all 3 applications.

We would be grateful if you could inform us of this information as soon as possible

Kind regards

Erika Davies

Deputy Clerk

Phone | Ffon: 01495 217323

Website | Gwefan: <http://www.abertilleryandlanhilleth-wcc.gov.uk>

Council Offices, Mitre Street, Abertillery, Blaenau Gwent, NP13 1AE

Swyddfeydd y Cyngor, Heol Mitre, Abertillery, Blaenau Gwent, NP13 1AE

This email has been scanned for spam & viruses. If you believe this email should have been stopped by our filters, [click here](#) to report it.

Abertillery and Llanhilleth Community Council (ALCC)

Solar Farm Grant 2024 – Application

(see criteria and process attached before applying)

Name and Address of your group or organisation:

Abertillery Town Band

Contact name: ...Sian Millar

.....

Role in group: ...Secretary

.....

Telephone number:

.....

Email:

.....

What is the name of your project? ...Abertillery Music Academy and Community Hub

.....

.....

What are the aims of the project? Aims of the Music Academy... To provide free tuition and instruments for young people in Abertillery and surrounding district.

To provide brass and percussion tuition in a safe, social environment.

To provide performance opportunities for the Academy Band to entertain the local community.

To link with the local schools to provide a joint school and Band musical education.

Aims of the Community Outreach Component

To provide a hub for the community to attend and listen to concerts by the Academy Band.

To provide not only entertainment, but also refreshments and support.

To offer company and friendship for those who are lonely and who may find it difficult

to meet and relate to other people.

To offer the opportunity of inter-generational liaison which will benefit young and older alike.

To create the opportunity for the Band and the Church to be part of the Well-Being Network, helping to improve the health and well-being of those who attend the Academy Hub.

To play a part in achieving a stronger community, through partnership working.

.....
.....
.....
.....

How will your project benefit the Abertillery and Llanhilleth area or its residents? ...The Music Academy and Community Hub will provide a safe place for the young people of the area. The Academy will develop their musical skills and will also help to increase their confidence levels and improve social interaction. The Young People will experience the power of performance which so increases self-esteem and confidence. The Young People will find a purpose and goal to achieve whilst also establishing friendships. Some young people may also find career opportunities through music and performance.

The Community Hub will help link the young and old, with the older people enjoying the company of the young people and the young people learning to care for and relate to the older citizens who attend the Hub. The Hub will provide friendship and company - but it will be more than a cup of coffee and a chat. They will be entertained by the Academy Band, which gives an added focus for those who are more reserved and shy in social settings. We hope this approach will be more inclusive and put people at ease – linking people through the healing power of music.

.....

Approximate number of beneficiaries 150, including the children involved through the school......

What will be delivered as a result of the Solar Farm Grant? ...The purchase of resources to aid playing and tuition in the Academy and Senior Bands.....

.....
.....

Project costs:

A. Project costs met by your group	Amount (inc. VAT)
Free tuition and instruments provided for beginners. But need follow-on instruments and resources.	£
	£
	£
Sub Total	£
B. Funding being provided by other organisations	Amount (inc. VAT)
Beginners' Instruments funded through Community Voice Community Choice	£ 7,633
ALCC Funding for workshops	£ 2,040
Sub Total	£9673
C. Funding requested from ALCC Solar Farm Grant	Amount (inc. VAT)
Tuners	£300
Cornet Straight Mutes	£200
Cornet Cup Mutes	£300
Refurbishment of 2 baritones	£2000
Refurbishment of 1 Trombone	£1000
Refurbishment of E Flat Bass	£3500
Sub Total	£ 7300
D. Total project costs (A + B + C)	TOTAL
	£ 16,973

How will your project improve the local environment? ... The plans to refurbish the church building to provide appropriate facilities for the Music Academy will help to maintain and improve the environment around the church. The building will be refurbished taking account of environmental benefits and energy efficiency.

.....

.....

.....

.....

How does your project contribute to sustainability? Young People are the future of the brass band movement, and the Music Academy will encourage and inspire young people to make music and be involved in brass banding. This is essential for the sustainability of the brass band movement and provides numerous benefits to young people.

The Project, with the Academy Hub and Community Outreach will help sustain the church and the local community, providing support and help to those in need –

building a stronger community.

How does your project link with local schools? ... The link with local schools is an important element of the Academy and the band has provided instruments for school use.....

How does your project promote volunteering? ... There are opportunities for volunteers to work in the Hub with the preparation and distribution of refreshments, talking to Hub attenders, helping with IT facilities, distribution of food and clothing if needed.....

How does your project promote links between communities? There are no demarcation lines – the school children will be from across Abertillery and Llanhilleth and it will be an open invitation to attend the Academy and the Hub. We will continue to support our communities by playing at community events right across the area.

How does your project help deliver the seven well-being goals in the Well-being of Future Generations (Wales) Act 2015, namely:

- A prosperous Wales
- A resilient Wales
- A healthier Wales
- A more equal Wales
- A Wales of cohesive communities
- A Wales of vibrant culture
- A globally responsible Wales?

.....Our project will help build more **resilient communities** by tackling social isolation and by offering a structured hobby for young people providing purpose and learning as well as fun!

We will teach our young people to care for each other and those in our communities and to treat others with dignity and respect. We believe these are essential building blocks to create resilient communities.

Our project will contribute to a **healthier Wales** by providing a space for the more vulnerable members of our communities to find company and friendship - the well-being benefits of friendship is well documented as is the power of inter-generational links.

We will be equal and inclusive, welcoming all, regardless of background, gender, race or ability and our project has music at its heart with an emphasis on performance – this will contribute to a **Wales of vibrant culture**.

We will also seek to ensure that there are career opportunities available for our young people attending the Academy and encourage advancement and employment where we can.

(continue on a separate sheet if needed)

If funding is granted, what will successful delivery of the project look like?
An established Music Academy for Young People with appropriate

resources, instruments and free tuition. Also providing workshops throughout the year.

A better sustained and equipped Senior Band to which the learners can progress.

A better sustained Church at Blaenau Gwent Methodist.

An established Community Hub linking the Academy, Band and Church to the local community.

The inclusion of music at the heart of the community.

.....
.....
.....
.....

Will you (and when will you) supply completion reports / evidence / photos?

.....
..... Yes.....
.....
.....

Is your organisation a: Charity/community group/sports club/company/not for profit business/other (explain and provide evidence)

.....
... Charity – Charity Commission Number 1039267
.....
.....
.....

Payee name:

Signed:

.S.Millar.....

Print Name: SIAN MILLAR

.....

Date: ...22.05.24.....

This form must be submitted with any relevant supporting documents you wish to submit (e.g. business plan, group constitution, bank or financial statements, letters of support etc) to Abertillery and Llanhilleth Community Council by Friday 31st May 2024, either by post to Town Clerk, Abertillery and Llanhilleth Community Council, Mitre Street, Abertillery, NP13 1AE or email clerk@abertilleryandllanhilleth-wcc.gov.uk.

Abertillery and Llanhilleth Community Council (ALCC)

Solar Farm Grant 2024 – Application

(see criteria and process attached before applying)

Name and Address of your group or organisation:

Abertillery Town Band and Blaenau Gwent Methodist Church

Contact name: ...Sian Millar

Role in group: ...Secretary

Telephone number: [REDACTED]

Email: [REDACTED]

What is the name of your project? ...Abertillery Music Academy and Community Hub

What are the aims of the project? Aims of the Music Academy... To provide free tuition and instruments for young people in Abertillery and surrounding district.
To provide brass and percussion tuition in a safe, social environment.
To provide performance opportunities for the Academy Band to entertain the local community.
To link with the local schools to provide a joint school and Band musical education.

Aims of the Community Outreach Component

To provide a hub for the community to attend and listen to concerts by the Academy Band.
To provide not only entertainment, but also refreshments and support.
To offer company and friendship for those who are lonely and who may find it difficult

- to meet and relate to other people.
 - To offer the opportunity of inter-generational liaison which will benefit young and older alike.
 - To create the opportunity for the Band and the Church to be part of the Well-Being Network, helping to improve the health and well-being of those who attend the Academy Hub.
 - To play a part in achieving a stronger community, through partnership working.
-
-
-
-

How will your project benefit the Abertillery and Llanhilleth area or its residents? ...The Music Academy and Community Hub will provide a safe place for the young people of the area. The Academy will develop their musical skills and will also help to increase their confidence levels and improve social interaction. The Young People will experience the power of performance which so increases self-esteem and confidence. The Young People will find a purpose and goal to achieve whilst also establishing friendships. Some young people may also find career opportunities through music and performance.

The Community Hub will help link the young and old, with the older people enjoying the company of the young people and the young people learning to care for and relate to the older citizens who attend the Hub. The Hub will provide friendship and company - but it will be more than a cup of coffee and a chat. They will be entertained by the Academy Band, which gives an added focus for those who are more reserved and shy in social settings. We hope this approach will be more inclusive and put people at ease – linking people through the healing power of music.

.....

Approximate number of beneficiaries 150, including the children involved through the school......

What will be delivered as a result of the Solar Farm Grant? ...In order to develop the Music Academy and the Community Hub the Church Building needs to be reconfigured to ensure its fit for purpose as an Academy, Rehearsal and Storage space and Café and Hub. The Band and Church have worked together with an architect to develop plans to reconfigure the space. An agreed plan has been established and the next stage is to work with a technical Design Team to develop the scheme, cost it appropriately and help to source the capital for the build. Tender documents were written, and an approved bid received. The Solar Farm Grant, if allocated, would help provide the funds to appoint the Design Team. Attached are copies of the plans and the brief from Jonathan Salt Associates, the firm which

provided the approved tender.....

.....

.....

Project costs:

A. Project costs met by your group	Amount (inc. VAT)
Free tuition and instruments provided for beginners. But need follow-on instruments and resources.	£
	£
	£
Sub Total	£
B. Funding being provided by other organisations	Amount (inc.VAT)
Beginners' Instruments funded through Community Voice Community Choice	£ 7,633
ALCC Funding for workshops	£ 2,040
Sub Total	£9673
C. Funding requested from ALCC Solar Farm Grant	Amount (inc.VAT)
To appoint a multi-disciplinary team of engineers, project manager and a quantity surveyor will cost 10% of the overall building cost. This equates to £30,000: Development Phase Work	19,500
Delivery Phase Work	10,500
Sub Total	30,000
D. Total project costs (A + B + C)	TOTAL
	39,673

How will your project improve the local environment? ... The plans to refurbish the church building to provide appropriate facilities for the Music Academy will help to maintain and improve the environment around the church. The building will be

refurbished taking account of environmental benefits and energy efficiency.

.....

.....

.....

.....

How does your project contribute to sustainability? Young People are the future of the brass band movement, and the Music Academy will encourage and inspire young people to make music and be involved in brass banding. This is essential for the sustainability of the brass band movement and provides numerous benefits to young people.

The Project, with the Academy Hub and Community Outreach will help sustain the church and the local community, providing support and help to those in need – building a stronger community.

.....

.....

.....

How does your project link with local schools? ... The link with local schools is an important element of the Academy and the band has provided instruments for school use.....

.....

.....

.....

How does your project promote volunteering? ... There are opportunities for volunteers to work in the Hub with the preparation and distribution of refreshments, talking to Hub attenders, helping with IT facilities, distribution of food and clothing if needed.....

.....

.....

.....

How does your project promote links between communities? There are no demarcation lines – the school children will be from across Abertillery and Llanhilleth and it will be an open invitation to attend the Academy and the Hub. We will continue to support our communities by playing at community events right across the area.

.....

.....

.....

.....

How does your project help deliver the seven well-being goals in the Well-

being of Future Generations (Wales) Act 2015, namely:

- **A prosperous Wales**
- **A resilient Wales**
- **A healthier Wales**
- **A more equal Wales**
- **A Wales of cohesive communities**
- **A Wales of vibrant culture**
- **A globally responsible Wales?**

.....Our project will help build more **resilient communities** by tackling social isolation and by offering a structured hobby for young people providing purpose and learning as well as fun!

We will teach our young people to care for each other and those in our communities and to treat others with dignity and respect. We believe these are essential building blocks to create resilient communities.

Our project will contribute to a healthier Wales by providing a space for the more vulnerable members of our communities to find company and friendship - the well-being benefits of friendship is well documented as is the power of inter-generational links.

We will be equal and inclusive, welcoming all, regardless of background, gender, race or ability and our project has music at its heart with an emphasis on performance – this will contribute to a Wales of vibrant culture.

We will also seek to ensure that there are career opportunities available for our young people attending the Academy and encourage advancement and employment where we can.

[illegible]

.....

.....

.....

.....

.....

.....

.....

.....

.....

.....

(continue on a separate sheet if needed)

If funding is granted, what will successful delivery of the project look like?

.....An established Music Academy for Young People with appropriate
resources, instruments and free tuition. Also providing
workshops throughout the year.

A better sustained and equipped Senior Band to which the learners can progress.

A better sustained Church at Blaenau Gwent Methodist.

An established Community Hub linking the Academy, Band and Church to the local
community.

The inclusion of music at the heart of the community.

.....

.....

.....

.....

Will you (and when will you) supply completion reports / evidence / photos?

.....

.....Yes.....

.....

.....

Is your organisation a: Charity/community group/sports club/company/not for
profit business/other (explain and provide evidence)

.....

.....Charity – Charity Commission Number 1039267

.....

.....

.....

Payee name:

Signed: S Millar

.....

Print Name: ...SIAN MILLAR

.....

Date: ...22.5.24.....

This form must be submitted with any relevant supporting documents you wish to submit (e.g. business plan, group constitution, bank or financial statements, letters of support etc) to Abertillery and Llanhilleth Community Council by Friday 31st May 2024, either by post to Town Clerk, Abertillery and Llanhilleth Community Council, Mitre Street, Abertillery, NP13 1AE or email clerk@abertilleryandllanhilleth-wcc.gov.uk.

1

Abertillery and Llanhilleth Community Council (ALCC)

Solar Farm Grant 2024 – Application

(see criteria and process attached before applying)

Name and Address of your group or organisation:

FRIENDS OF BLAENAU GWENT VILLAGE AND
ROSEHEYWORTH PARK

Contact

...

Role in

..

Telephone

..

Email:

rk@

What is the name of your project?

Roseheyworth park renovation

What are the aims of the project?

To implement new play equipment where the previous equipment was originally. To provide a stimulating, inviting environment where the local community can come together. To ensure this area remains accessible to the local community.

How will your project benefit the Abertillery and Llanhilleth area or its residents?

The refurbishment will invigorate the play area and benefit the community of Roseheyworth + Blaenau Gwent by providing a better equipped play area. It will benefit children of all ages and their parents/careers by providing an appealing and inclusive play space.

6

.....
Approximate number of beneficiaries

4500
.....

What will be delivered as a result of the Solar Farm Grant?

A new and improved play area for the local community where communities can come together in an enriched inviting environment.

Project costs:

A. Project costs met by your group	Amount (inc. VAT)
	£
	£
	£
Sub Total	£ 0
B. Funding being provided by other organisations	Amount (inc. VAT)
	£
	£
Sub Total	£ 0
C. Funding requested from ALCC Solar Farm Grant	Amount (inc. VAT)
PLAY EQUIPMENT	£ 25606
PARK BENCH x1 460	£
Picnic table x3 2790 + 20% tax	Sub Total £ 3900
D. Total project costs (A + B + C)	TOTAL £ 29,506

How will your project improve the local environment?

It will improve the local environment by ensuring that all the Green areas are maintained with the help of BLCC. We will ensure that areas are kept litter free and items are recycled where possible. The Park will be kept in good condition and well maintained.

How does your project contribute to sustainability?

We will be more efficient in regards to reducing waste cutting down delivery cost by using local suppliers and reallocating resources more efficiently.

It will also provide new play equipment that can be regularly checked and maintained plus replaced every few years. Instead of nothing there presently.

* ENCOURAGED TO VOLUNTEER WITHIN THE PROJECTS *

How does your project link with local schools?

The project will encourage all the children of the community and the local schools to participate in recreational activities improving their mental well-being, their physical well-being and community inclusiveness. These children will be

How does your project promote volunteering?

All participants to the group are volunteers and all members of the community able to participate on a voluntary basis.

How does your project promote links between communities?

BGCBC undertook a play area review in 2013 which identified Roseheym as a play area with play value and recommended it for closure.

* Please go to PG 5 *

③ **How does your project help deliver the seven well-being goals in the Well-being of Future Generations (Wales) Act 2015, namely:**

- A prosperous Wales
- A resilient Wales
- A healthier Wales
- A more equal Wales
- A Wales of cohesive communities
- A Wales of vibrant culture
- A globally responsible Wales?

All resources used for this project will be local. The project encourages recycling, reducing waste and fly tipping by regular litter picking. The project is also redirected the natural springs which in turn has reduced flooding in the parking area.

This project will increase physical activity which will enhance the community. Children's mental and physical well-being. It will also bring the community together increase social well-being and feelings of inclusiveness.

All walks of the community will be encouraged to participate in this project... (ptc)...

④

④

Everyone in the community will have access to the facilities, enabling them to have the same social and health opportunities that will be provided by the new park.

This project will increase physical activity which will enhance the community by bringing people together, providing play opportunities for their children and others. This in turn will bring the local community together in achieving their goal. It will give them a sense of achievement and well being.

It encourages recycling and using locally sourced materials. We will ensure that the supply chain we use is fair and ethical. The project will ensure that the park is welcome and safe and opportunity for people to engage with others from their own and other cultures.

(continue on a separate sheet if needed)

If funding is granted, what will successful delivery of the project look like?

There will be new play equipment in the park area. Benches and picnic tables in the green area of the park.

Will you (and when will you) supply completion reports / evidence / photos?

Yes, once all the renovations are complete or within 12 months.

Is your organisation a:

Charity/community group/sports club/company/not for profit business/other (explain and provide evidence)

We are a non profit community group. Evidence of this is included in this application.

- * Constitution
- * Bank Statements

Payee name:

④

5

CATHERINE SHARKEY

Signe

Print Name

MRS CATHERINE SHARKEY

Date:

14/8/2024

This form must be submitted with any relevant supporting documents you wish to submit (e.g. business plan, group constitution, bank or financial statements, letters of support etc) to Abertillery and Llanhilleth Community Council by Friday 31st May 2024, either by post to Town Clerk, Abertillery and Llanhilleth Community Council, Mitre Street, Abertillery, NP13 1AE or email clerk@abertilleryandllanhilleth-wcc.gov.uk.

* From Page 3 *

④ However, the Community with the support of local members have campaigned against the closure and have formed a Community group known as "Friends of Blaenau Gwent and Rosehegwon Park" to work in partnership with the Council to improve the park for the benefit of the Community both young and old. The work carried out so far by the group has resulted in a positive impact with litter clean ups, painting and horticulture works undertaken that has seen an increase in volunteers and a decrease in anti-social behaviour due to the "Community ownership".

As the play area is central to the park, it is felt that by refurbishing it, will further improve the Community by in and make it a pleasant and inviting area for families to visit safely. BGCBC have committed to renege its closure decision and support the Community group by maintaining the statutory maintenance and (PTO) (15)

inspection regime and retain insurance
liability * (Back To Page 3) *

Constitution for Friends of Blaenau Gwent & Roseheyworth Park.

1. Name

Friends of Blaenau Gwent & Roseheyworth Park

2. Aims

The aims of Friends of Blaenau Gwent & Roseheyworth Park will be:

- To bring improvements to the area and park that are currently not being provided as a service by the council.
- To work with the local council to ensure the local area and park is in a good state of repair.

3. Membership

Membership is open to anyone who:

- is aged over 18; and

individual concerned shall have the right to be heard by the management committee, accompanied by a friend, before a final decision is made.

4. Equal Opportunities

Friends of Blaenau Gwent & Roseheyworth Park will not discriminate on the grounds of sex, race (including colour, ethnic or national origin), sexual orientation, disability, gender reassignment, religious or political belief, pregnancy or maternity, marital status or age.

5. Officers and committee

The business of the group will be carried out by a Committee elected at the Annual General Meeting. The Committee will meet as necessary and not less than four times a year.

The Committee will consist of 6 members, and be composed of 3 officers and 3 committee members. Up to 2 additional members may be co-opted onto the committee at the discretion of the committee.

The officers' roles are as follows:

- Chair, who shall chair both general and committee meetings
- Secretary, who shall be responsible for the taking of minutes and the distribution of all papers
- Treasurer who shall be responsible for maintaining accounts

In the event of an officer standing down during the year a replacement will be elected by the next General Meeting of members.

Any committee member not attending a meeting without apology for three months will be contacted by the committee and asked if they wish to resign.

The Committee meetings will be open to any member of Friends of Blaenau Gwent & Roseheyworth Park wishing to attend, who may speak but not vote.

6. Meetings

General Meetings are open to all members and will be held at least once every 3 months or more often if necessary.

All members will be given two weeks' notice of such a meeting, giving the venue, date, time and agenda, and notice may be by telephone, email or post.

The quorum for a General Meeting shall be 1 % of the membership or 4 members, whichever is the greater number.

6.4 Committee Meetings

Committee meetings may be called by the Chair or Secretary. Committee members must receive notice of meetings at least 7 days before the meeting.

The quorum for Committee meetings is three Committee members.

7. Rules of Procedure for meetings

All questions that arise at any meeting will be discussed openly and the meeting will seek to find general agreement that everyone present can agree to.

If a consensus cannot be reached a vote will be taken and a decision will be made by a simple majority of members present. If the number of votes cast on each side is equal, the chair of the meeting shall have an additional casting vote.

8. Finances

An account will be maintained on behalf of the Association at a bank agreed by the committee. Three cheque signatories will be nominated by the Committee (one to be the Treasurer). The signatories must not be related nor members of the same household.

All payments will be signed by two of the signatories.

- For cheque payments, the signatories will sign the cheque.

Signed

Name and position in group

Signed

COUNCIL OFFICES
MITRE STREET
ABERTULLERY
GWENT
NP13 1AE

DEAR COUNCILLOR,

17TH JANUARY 2024

I AM ADDING MY CUNTILLERY WARD
COMMUNITY COUNCILLOR BACKING TO THE FRIENDS OF
BLAENAU GWENT AND ROSEHEYWORTH PARK ALCC GRANT
FUNDING APPLICATION FOR THE TOTAL SUM OF \$6100 FOR
THE PURCHASE AND INSTALLATION OF A

1 x PARK BENCH

3 x PICNIC TABLES

AFTER MEETING 2 x MURALS

AND SPEAKING WITH THE FRIENDS OF
BLAENAU GWENT AND ROSEHEYWORTH PARK CHAIRMAN
MARK LEWIS AND ITS TREASURER DAN NICHOLAS REAGAN
AT ROSEHEYWORTH PARK ABOUT THE LOCAL COMMUNITY
GROUP'S PROJECT IDEAS FOR THE PARK, IT WAS EXPLAINED
TO ME WHERE THE ABOVE MENTIONED ALCC FUNDING
REQUEST WOULD BE SPENT PLUS ALSO BE LOCATED
AND POSITIONED WITHIN ROSEHEYWORTH PARK ITSELF
WITHIN MY LOCAL WARD AREA THAT I REPRESENT
IN CUNTILLERY.

THIS LOCAL COMMUNITY GROUP APPLIED FOR THE
RECENT ALCC / SOLAR FARM FUNDING THAT WAS
AVAILABLE IN LATE 2023 BUT UNFORTUNATELY
NARROWLY MISSED OUT ON OBTAINING THIS FUNDING
WHICH WAS BADLY REQUIRED WITHIN THE ROSEHEY WORTH
AND BLAENAU GWENT AREAS WITHIN MY CUNTILLERY

WARD AREA BOTH THESE ABOVE MENTIONED ALCC
AREAS, HAVE RECEIVED NONE TO MINIMAL FUNDING FROM
ALCC WITHIN THE LAST SEVEN YEARS

AND GIVEN THAT C3 PLANTERS ITS RESIDENTS HELP TO
MAKE UP 25 PERCENT OF THE CWMILLERY WARD AND
OVERALL ALCC POPULATION PLUS CONTRIBUTE TO
27-28 PERCENT OF THE ALCC BUDGET IT IS NOW
HIGH TIME THAT THE RESIDENTS LIVING WITHIN THESE
ABOVE MENTIONED ALCC AREAS RECEIVED SOMETHING
BACK FOR THE CONTRIBUTIONS THAT THEY ARE
CONTRIBUTING IN COMMUNITY COUNCIL TAX TO ALCC
ON A YEARLY BASIS

COMMUNITY COUNCIL TAX CONTRIBUTIONS FOR
THE CWMILLERY WARD RESIDENTS FOR 2024-25
WILL BE

£106-716-68

THIS IS ONE HELL OF A LOT OF MONEY FOR MY
CWMILLERY WARD RESIDENTS TO BE CONTRIBUTING
TOWARDS THE ALCC BUDGET TO RECEIVE VERY LITTLE
TO NOTHING SPENT IN THE CWMILLERY WARD
AREA IN RETURN

IT IS NOW TIME FOR THE CWMILLERY WARD AND
ITS RESIDENTS TO RECEIVE SOMETHING BACK
IN ALCC SPENDING IN RETURN FOR THEIR PASSIVE
CONTRIBUTIONS TOWARDS THE OVERALL ALCC BUDGET
ESPECIALLY WHEN THE AREA IS CRYING OUT FOR IT
AND YOU COMPARE IT TO WHAT ALCC IS SPENDING
REGULARLY YEARLY IN OTHER ALCC WARD AREAS

REGARDS

COUNCILLOR BERNARD CHARLES WALL

COMMUNITY & COUNCILLOR CWMILLERY WARD

PROPRIETARY & LANDLORD COMMUNITY COUNCIL



Blaenau Gwent areas within my Cwmtillery Ward area.

Both these above-mentioned ALCC areas have received ^{NONE TO} ~~NO~~ MINIMAL funding from ALCC within the last seven years and given that ^{(3 PLANT} ~~ERS)~~ it's residents help to make up 25 percent of the Cwmtillery Ward and overall ALCC population plus contribute to 27 - 28 percent of the ALCC Budget it is now high time that the residents living within these above mentioned ALCC areas received something back for the contributions that they are contributing in Community Council Tax to ALCC on a yearly basis.

Community Council Tax Contributions for the Cwmtillery Ward Residents for 2024-25 ^{WILL BE}

£ 106,716.68

This is one hell of a lot of money for my Cwmtillery Ward residents to be contributing towards the ALCC Budget to receive very little to nothing spent in the Cwmtillery Ward area in return.

It is now time for the Cwmtillery Ward and its residents to receive something back in ALCC spending in return for their massive contributions towards the overall ALCC Budget especially when the area is crying out for it and you compare it to what ALCC is spending regularly yearly in other ALCC Ward areas.

Regards,

Councillor Bernard Wall,
Community Councillor Cwmtillery Ward,
Abertillery & Llanhilleth Community Council.

LLOYDS BANK



Your account statement

Issue date: 14 July 2023

Write to us at: PO Box 1000, Andover, BX1 1LT

Call us on: 0345 072 5555 (from UK)
+44 1733 347338 (from Overseas)

Visit us online: www.lloydsbank.com



TREASURERS ACCOUNT

FRIENDS OF BLAENAU GWENT VILLAGE

INTEREST RATES FOR THE PERIOD 10 JUN 23 TO 10 JUL 23

Debit Rates 10 JUN 23 - 21 JUN 23
Unauthorised Borrowing 15.35% pa

Debit Rates 22 JUN 23 - 10 JUL 23
Unauthorised Borrowing 15.85% pa

PLGFOXA3100000

NA31DTF030270 DA31DTF030280

Page 3 of 4 / 0028073 / 0132567

Unless otherwise specified in the account charges brochure which applies to this account, the charges for unauthorised borrowing and unpaid items are set out below

Unauthorised borrowing fee: £0.00

Unpaid item (cheque): £0.00

Unpaid item (direct debit): £0.00

Unpaid item (standing order): £0.00

If your account becomes overdrawn, or you exceed any agreed overdraft limit, we may allow an overdraft to be created or allow the agreed overdraft limit to be exceeded. In these circumstances the new or excess overdraft is an unauthorised overdraft and you will be charged at the rate for unauthorised borrowing which is shown on your statement and will incur other unauthorised borrowing charges shown above.

Interest is calculated on the cleared daily balance of the new or excess overdraft and is payable for the duration of the new or excess overdraft.

We may change any of our charges and interest at any time and will notify you in writing at least two months before we make any change. You will be deemed to have accepted any such change if you do not notify us to the contrary before the date any such change comes into effect. However, if you choose not to accept any change:

- You can close the account at any time before the change comes into effect provided that any outstanding amounts on the account are paid; or
- Our notice of the change shall be deemed to be notice of termination given under the terms of your account and your account Agreement will terminate the day before any change comes into effect. Should there be any outstanding balance on the account it will become immediately due and payable on termination.

When we tell you about a change we will do so by letter, e-mail, text, statement, statement inserts or messages or in any other way which is sent to you individually.

If the change is to your advantage we may change our interest rates at any time and without notice to you. We will tell you about the change by putting notices in our branches within three Business Days of making the change or by telling you personally within 30 days of making the change and we will update our website within three Business Days of an interest rate change taking effect.

LLOYDS BANK



Your account statement

Issue date: 14 July 2023

Write to us at: PO Box 1000, Andover, BX1 1LT

Call us on: 0345 072 5555 (from UK)
+44 1733 347338 (from Overseas)

Visit us online: www.lloydsbank.com



TREASURERS ACCOUNT

FRIENDS OF BLAENAU GWENT VILLAGE

Account summary

Balance On 14 Apr 2023	£611.60
Total Paid In	£100.00
Total Paid Out	£0.00
Balance On 29 Jun 2023	£711.60

Account activity

Date	Payment Type	Details	Paid In (£)	Paid Out (£)	Balance (£)
14 Apr 23		STATEMENT OPENING BALANCE			611.60
29 Jun 23	BGC	BLAENAU GWENT CBC 00516559	100.00		711.60
29 Jun 23		STATEMENT CLOSING BALANCE	100.00	0.00	711.60

The "Details" column in your statement shows the date that a Debit Card payment went into or came out of your account only if that happened on a weekend or a Bank Holiday.

Payment types:

BGC - Bank Giro Credit

SECTION 4 Needs

0756 - ROSEHEYWORTH

Client: Blaenau Gwent County Borough Council
 Address: Brynmawr, NP23 4YF
 Quote Ref: T-0756 A
 Date: 08 September 2023

**SCHEDULE OF WORKS**

Item	Description	Quantity	Unit	Rate	Value
	<u>MEASURED WORKS</u>				
	<u>Pad 1 - 7m x 4m</u>				
1	Removal of existing rubber mats, including disposal;	28	m2	40.00	1,120.00
2	Regulate existing base to receive wetpour;	28	m2	20.00	560.00
3	Supply and install Wicksteed Mordred Unit; <i>Including slight adjustment to the base to accommodate the new item;</i>	1	Item		12,144.00
4	Supply and lay EPDM wetpour BLACK; 1.665 FH	13	m2	100.00	1,250.00
5	Supply and lay EPDM wetpour BLACK; 1.200 FH	16	m2	86.00	1,333.00
	<u>Pad 2 - 5m x 5m</u>				
6	Removal of existing rubber mats, including disposal;	25	m2	40.00	1,000.00
7	Regulate existing base to receive wetpour;	25	m2	20.00	500.00
8	Supply and install Wicksteed Rock N Bowl;	1	Item		4,262.00
9	Supply and lay EPDM wetpour BLACK; 1.000 FH	25	m2	79.00	1,975.00
	<u>Pad 3 - 2m x 3m</u>				
10	Removal of existing rubber mats, including disposal;	6	m2	40.00	240.00
11	Regulate existing base to receive wetpour;	6	m2	20.00	120.00
12	Supply and install Wicksteed Holly Hedgehog;	1	Item		2,075.00
13	Supply and lay EPDM wetpour BLACK; 1.000 FH	6	m2	79.00	474.00
	<u>PRELIMINARIES</u>				
14	Heras / Toilet / Mobiliation	1	Sum		400.00
	Line Discount				-1,847.00
TOTAL VALUE (£)					25,606.00

All prices are subject to VAT



What are you looking for?

Product Book Favourites

Your Favourite Play Equipment

View, update or remove your favourites

Products/playground-essentials/springies/holly-hedgehog-springy



Products/playground-essentials/springies/holly-hedgehog-springy

Holly Hedgehog Springy

Remove

Products/playground-essentials/springies/holly-hedgehog-springy

Products/multiplay-equipment/castle-multi-play-system/mordred-multi-play-unit



Products/multiplay-equipment/castle-multi-play-system/mordred-multi-play-unit

Mordred Multiplay Unit

Remove

Products/multiplay-equipment/castle-multi-play-system/mordred-multi-play-unit

Products/playground-essentials/roundabouts/rock-n-bowl-roundabout



Products/playground-essentials/roundabouts/rock-n-bowl-roundabout

Rock 'n' Bowl Roundabout

Remove

Products/playground-essentials/roundabouts/rock-n-bowl-roundabout



Products

Products (/products)
Climbing Equipment (/products/climbing-activity)

Sectors

School Playground Equipment (/sectors/schools)

Services

Playground Inspection Services (/services/playground-inspection)

Explore

About Us (/about)
Contact Us

Let's talk

